

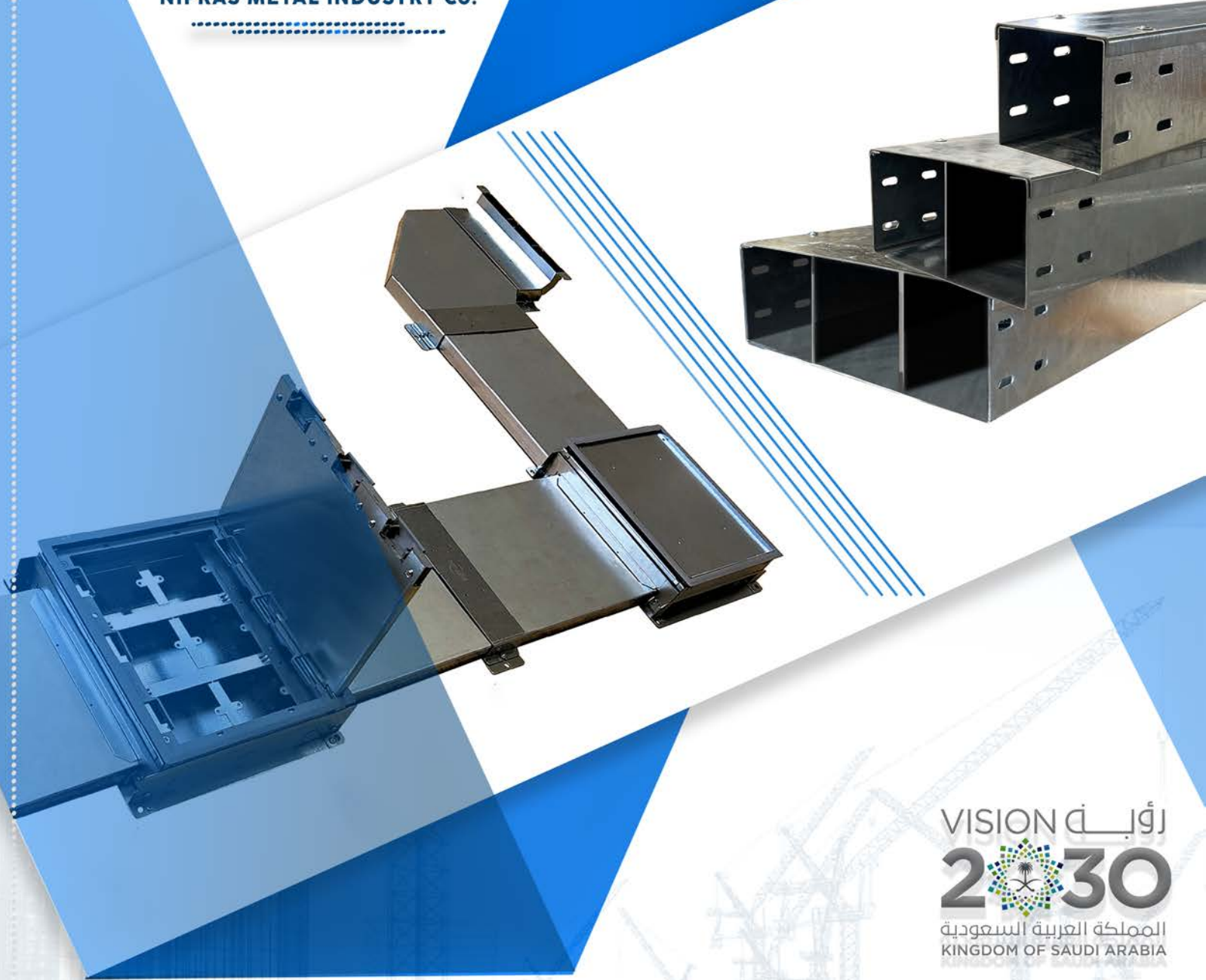

شركة نبراس المعدن للصناعة
NIPRAS METAL INDUSTRY Co.



رؤية
VISION
2030
المملكة العربية السعودية
KINGDOM OF SAUDI ARABIA

CABLE TRUNK CATALOGUE .



NMG NIPRAS
METAL GROUP



NIPRAS Best Practice Guide to cable ladder and Cable Tray Systems including channel support systems and other associated supports.

The information contained in this catalogue has been carefully compiled but we do not accept any responsibility for loss caused by any error contained herein. We reserve the right to alter prices without prior notice.

We reserve the right to make technical changes or modify the contents of this document without prior notice. With regard to purchase orders, the agreed particulars shall prevail. **NIPRAS** does not accept any responsibility whatsoever for potential errors or possible lack of information in this document. We reserve all rights in this document and in the subject matter and illustrations contained therein. Any reproduction, disclosure to third parties or utilization of its contents – in whole or in parts – is forbidden without prior written consent of **NIPRAS**.

In case of any questions or remarks, feel free to contact the R&D Department via www.nipras.sa



INDEX

About Us	Pg. 02
Factory Location & Photos.	Pg. 05
Research & Development (R&D) Department.	Pg. 06
Technical Team.	Pg. 07
Social Awareness.	Pg. 08
Health & Safety.	Pg. 10
Machinery.	Pg. 11
Materials We Use & Standards.	Pg. 12
Cable Trunk.	Pg. 14-20
Cable Trunk Accessories & Fittings.	Pg. 21-58
Order Codes.	Pg. 64
Range Of Products.	Pg. 65-72
Quality Page.	Pg. 73



ABOUT US

Nipras Metal Group is a diversified private enterprise and a Saudi organization established in 2010 with a vision to be a preferred partner for our valuable clients in supplying quality and cost effective building construction and Architectural engineering solutions. Since the establishment of Nipras, we have been partnered with major organizations in the kingdom to consistently serve their projects and, we have engaged closely with many key contractors and consultants by meeting their expectations in providing high-quality and certified construction and Architectural products. **Nipras group** operates its business units from three divisions in manufacturing, supplying and sub-contracting of various Architectural products such as Roof Hatch Access, Gratings, Railings, Raised Floors, Garbage Chute System, Cable tray management solutions, and all types of stainless steel & metal fabrication and other building construction materials. The company has two production lines of Architectural products and cable management systems.

At **Nipras** we always strive hard to supply and meet our client's requirements with high-quality products quickly and efficiently. The company adopts modern management concept, adheres to survival by quality and development by integrity, and gradually boarded the local competition platform. We rely on service to enhance the client relationship, sincerely create value for customers, and provide customers with high-quality and reliable products and wholehearted service. Our company has advanced production equipment which guarantees the most advantageous product quality and efficiency.

Nipras is accredited through various quality certifications and standards meeting all project's technical criteria and consultant approvals. We are an ISO-1519 certified company to ensure the quality, safety, and efficiency of our products. We gain trust of our existing clients and new customers with the best products, the best quality, competitive price and the most perfect service.



Vision

Nipras strives to strengthen its manufacturing base in the steel industry to serve the kingdom and contribute to its vision through effective utilization of staff and materials with cutting-edge technology and high productivity, consistent with modern management practices.

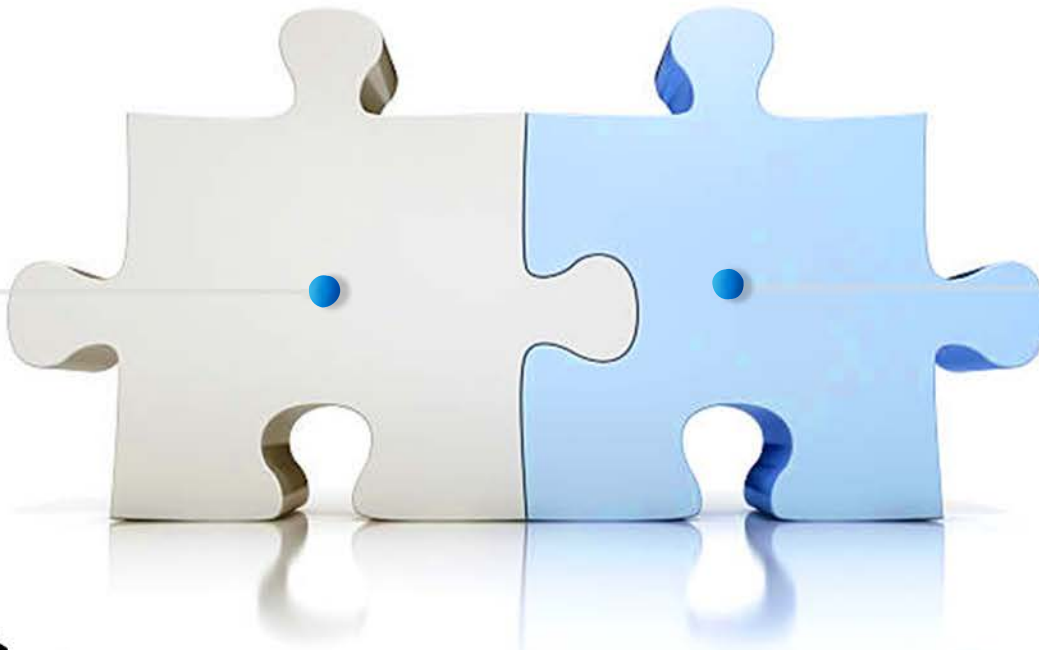

Mission

To be a preferred partner for our valuable customers and consistently exceeds our customer's needs and expectations in quality, delivery, and cost through continuous improvement and enhancing **customer satisfaction**. We go all out to manufacture, deliver and supply superior steel and metal products to our clients utilizing sustainable procedures that meet the international standards.

The aim of **NIPRAS** is to fabricate steel and metal work in the construction sector by the development of standards to turn raw metal into Architectural engineering solutions that can be used in construction.



To seek a competitive advantage by developing partnerships with clients, suppliers and subcontractors.

OBJECTIVES



Riyadh Gate Industrial City
Al-Musafa district
6353

https://www.google.com/maps?q=24.4828100,46.8915030&hl=en-SA&gl=sa&entry=gps&g_ep=CAISBjYuMzQuMxgAINECAw%3D%3D&g_st=iw

||| Nipras Metal Group.

✉ Email: info@nipras.sa

☎ Sales: 056 880 5050



Research & Development

R & D refers to two intertwined processes of research (to identify new knowledge and ideas) and development (turning the ideas into tangible products or processes)



Our **Research and development (R&D)** department includes activities that we undertake to innovate and introduce new products and services.



Nipras R&D's mission is to:

Develop products that create value for customers and expand the use of NIPRAS products worldwide..

Improve NIPRAS competitiveness by developing new industrial processes – and optimising existing ones – to reduce cost and improve quality..

Contribute to sustainable development by reducing the environmental impact of products and processes.

Continuously upgrade NIPRAS scientific knowledge and attract technical talent.



Technical Division is entrusted with the work in respect of various subjects of technical nature via Research & Development, Energy & Environment Management, Standardization & Quality Control of products, etc. The work being dealt with by this division may be grouped under few categories namely:

- ✓ Research & Development in Metal & Steel Fabrication.
- ✓ Technical Regulations on the Products to promote quality.
- ✓ Technical Inputs on the ongoing / future products etc.



TECHNICAL TEAM

Lead with Engineers and other professionals at **NIPRAS TECHNICAL DEPARTMENT**, we access a vast array of advanced, highly sophisticated testing, modelling, failure analysis and other resources to develop the next generation of products, where the future is born.

SOCIAL RESPONSIBILITY



We "NIPRAS" ability to sense, understand and react to others emotions while comprehending on social networks. (Social awareness which encompasses the competency of empathy is the ability to read nonverbal cues for negative emotions, particularly anger and fear and to judge the trustworthiness of others.



It is about understanding others feelings, not experiencing them (Garner, 2009). NIPRAS accentuates on an individual's ability to identify, perceive and react to other's emotions while being a part of the social network circuitry. NIPRAS understand the ability to and be compassionate to the feelings, views, opinions and challenges of other people. Social-awareness cannot only be equated with understanding people's need but as well as caring for them (Goleman, 2006).



EMPLOYEES

At **NIPRAS** we empower our employees to leverage the corporate resources at their disposal to do well. Being a socially responsible company can bolster a company's image and build its brand.



CIVIL SOCIETY

According to the Saudi Youth in Numbers report, **37%** of the Saudi population is under 25. This entails that the youth will play a more significant role in undertaking the paths set by Vision 2030 and inheriting the future it's attempting to build.

NIPRAS gives our platform to the young for developing their sense of civic responsibility, involvement, and interconnectedness. Opportunities to equip the upcoming generation with the necessary skills and motivation to become active participants in their communities.

CUSTOMERS

A business cannot work without consumer. The survival and growth of business depends on consumer satisfaction, service and support.

"NIPRAS" winning the confidence of our customers made it possible by following a positive attitude towards customers and fulfilling our social responsibilities by providing them:

- ✓ Quality
- ✓ Fair Prices
- ✓ Honest advertising
- ✓ After sales service
- ✓ Research & Development for their requirements
- ✓ Safety
- ✓ Regular supply

ENVIRONMENT

NIPRAS understands the nature of the relationship between corporate adoption of the concept of societal responsibility [availability of environmental awareness, clear vision of the impact of societal responsibility on financial performance, managers informing employees of the latest developments in societal responsibility programs, managers' response to their corporate social responsibility (CSR) proposals] in the form of an annual report that supports the success of the company's objectives, the company's management encourages employees to participate collectively in societal responsibility programs and to protect the environment from pollution in the industry.

HEALTH & SAFETY

"NIPRAS" as a manufacturing Company for Metal & Steel Products has a large number of hazards because of the strong internal as well as external forward and backward linkages in terms of material flows. Employees are to work in hazardous environment because of complicated equipment layouts, high temperatures, heavy equipment's, moving machinery, hazardous processes, heavy lifting and movements of materials in the work environment etc. Further, several operations involve working at heights or in confined spaces. In short, working involves both very high volume as well as the complexity of operations which results into employees getting exposed to a high level of health and safety risks.



*The health, safety, and protection of our **employees**, equipment, and the environment are perfectly calculated and implied as a crucial since it affects both economic and social factors.. On the other hand, a healthy and safe workplace contributes towards plants competitiveness as well as in profit growth.*

ADVANCED MACHINERY



Standardized production lines meeting the complete requirements for the industry. Facility equipped with high end and advanced machinery “NIPRAS” serve our customers with topmost perfection. Our facility comprises with most high end technology where mentioned few are our key role players as - **Laser Cutting / Shearing Machines, CNC Bending Machines, CNC Punching Machines, Auto Welding Sets** and more.

MATERIALS Mild Steel - Plain

A. Hot rolled steel plates, sheets and coils s235 jr, As per :EN 10025-2 / DIN 17100 / BS 4360 / ASTM A653 | ASTM A 1011 ASTM A 1011-011-01 a/ JIS 3101 / JIS 3106 / GB 700 / T1 591ASTM A 907 / ASTM A 572 **B.** Cold Rolled Steel DC 01 , As per : EN 10130 / DIN 1623, Part 2 / BS 1449 :1 / ASTM A 1008 JIS G3141 / GB 699, EN 10131 / ASTM A 568M.



NOTE

**Note: All outdated standards / codes are replaced with new/ latest versions and the final product shall comply with the latest version*



MILD STEEL - Galvanized

C. Continuously Pre-Galvanized Hot-Di pp Zinc Coated Steel DX 51 D +Z, As per :EN 10327 / DIN 17162 / BS 2989 / ASTM /A527M / ASTM A653 M JIS G 3302.EN 10326 / EN 10142 / ASTM A 526, 527, 528 /ASTM A 146 **D.** Electro Galvanized Steel (Electrolytic Coating) DC01 + ZE As per :EN 10152 / DIN 17163 / ASTM A591 / JIS G3313 JIS G3141 / BS 1449:1 / EN 10131.



NOTE

All outdated standards / codes are replaced with new/ latest versions and the final product shall comply with the latest version

STAINLESS STEEL

F. Austenitic Stainless Steels AISI 304 & 316 As per: ASTM A240 / EN 10088 - 2 / DIN 17400 / BS 1449-2 ASTM A480 / ASTM A666 / ISO 3506 / EN 10028-7 JIS G4304 **F.1** Stainless Steel Fasteners EN 3506 **F.2** Stainless Steel Wire BS 1554, ASTM A 27

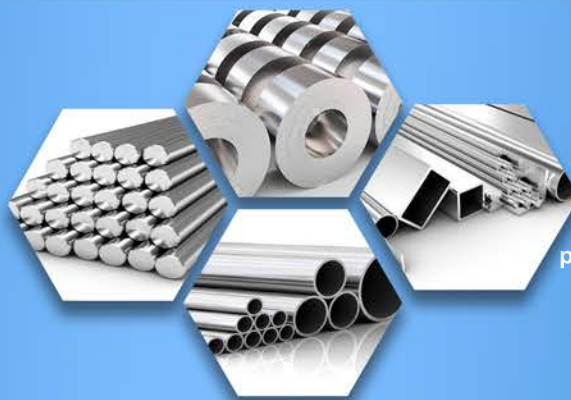

ALUMINIUM

G. Aluminium 5052 & 6063 **Note: All outdated standards / codes are replaced with new/ latest versions and the final product shall comply with the latest version.*

FINISHES

- 1. HOT - DIP Galvanization After Fabrication** As per :ASTM A 123 / ASTM A 153 / ISO 1461 BS 729 / DIN 50976 / BS EN 10143 / BS EN 10346
- 2. ZINC Electroplating After Fabrication** As per : ASTM B633 / EN 12329 / ISO 4042 / BS 1706 / BS 3382 DIN 50961
- 3. Powder Coating Epoxy / Polyester / Epoxy & Polyester** BS 3900 / 2409 / ISO 1519 / ISO 1520

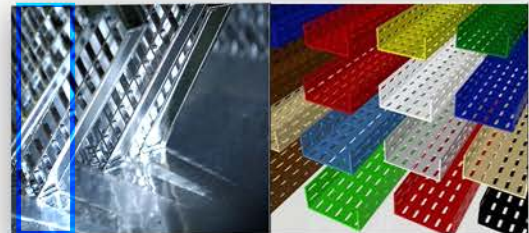

All outdated standards / codes are replaced with new/ latest versions and the final product shall comply with the latest version



CABLE MANAGEMENT SYSTEM

Cable management is the organization of cables connected to electrical devices. This includes power cables, network cables, audio/video cables, and many others. Managing cables is a key aspect of a clean and safe home or work environment.

NIPRAS METAL INDUSTRY Co. – Provides many cable support systems with specially designed supports that are easy to install and can support heavy duty cables along with others. Our best selling products are...

CABLE TRAY | CABLE LADDER | CABLE TRUNKS | CABLE BASKET (WIRE)

1

Cable Trays provide the most ideal answer for concealing and protecting all types of cables that are available in various widths, heights and thickness. **NIPRAS CABLE TRAY (NCT)** fabricated by single sheet (slotted/plain) is without any welding, provides a continuous support for the standard/custom lengths.

2

Cable ladders are utilized where heavy weighted cables are to be supported over long runs and extended supported spans. **NIPRAS CABLE LADDER (NCL)** covers up these loads with our wide range from light to heavy duty.



3

Cable Trunking with good aesthetically pleasing option is widely used to cover up the cables and have the freedom of movement throughout the installed area. **NIPRAS CABLE TRUNK (NCTR)** supplies the item with different standard/customised compartments within.

4

Wire Basket Tray System is an industry leading continuous cable basket and pathway support solution for today's high-performance cabling systems. Highly engineered features help ensure a secure installation that complies with industry codes and standards for high-performance cables. Clever design allows the installer to maximize field efficiency. **NIPRAS BASKET TRAY (NBT)** provides the perfect combination of performance, time savings and versatility required by today's DATACOM and electrical contractors.



شركة نبراس المعدن للصناعة
NIPRAS METAL INDUSTRY Co.



رؤية
VISION
2030
المملكة العربية السعودية
KINGDOM OF SAUDI ARABIA

CABLE TRUNK



NMG NIPRAS
METAL GROUP

CABLE TRUNK

Cable Trunking with good aesthetically pleasing option is widely used in laying any sensitive cables, instrument cables and light / heavy duty electrical cables for industrial and commercial buildings, malls, Airports etc. to cover up the cables and have the freedom of movement throughout the installed area.

NIPRAS CABLE TRUNK (NCTR) supplies the item with different standard / customised compartments within.

Manufacturing Standards—BS EN 50085-1 - 2005, BS EN 50085-2 -2006, SASO IEC (61084/2008), NEC (ANSI / NFPA 70), CSI Code 26 05 33

NOTE – BS 4678-1 surpassed by BS EN 50085-1-2005 and BS EN 50085-2-2006

DIFFERENT TYPES OF PRODUCT DESIGNS



Cable Tray-Solid

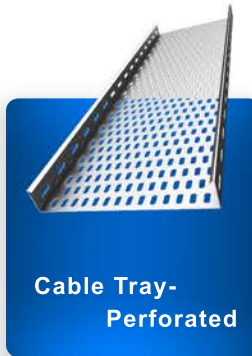

Cable Tray-
Perforated



Cable Ladder -
Swaged Rounded
Tubular



Cable Ladder -
Welded



Cable Trunking
(Solid)



Basket Tray
(Wire Mesh)

Material & Finish – Pre-Galvanized, Hot Dip Galvanized and Stainless Steel :

- Available in 3m lengths – Single, Double, Triple compartments with Lid and Coupler
- **NIPRAS Cable Trunking** comes in various thickness from 1.0mm, 1.5mm & 2mm.
- **Widths** ranges from 50mm, 75mm, 100mm, 150mm, 225mm, 300mm, 450mm, 600mm, 750mm, 900mm, etc

Other dimensions are available upon request.

Finishes - Pre-galvanized (Mill Galvanized) steel Stainless steel 304,316
Hot-dipped galvanized steel Coatings (BS or RAL number colour)



BS EN 50085-1

SCOPE

This **European Standard** specifies requirements and tests for cable trunking systems (CTS) and cable ducting systems (CDS) intended for the accommodation, and where necessary for the electrically protective separation, of insulated conductors, cables and possibly other electrical equipment in electrical and/or communication systems installations. The maximum voltage of these installations is 1 000 V a.c. and 1 500 V d.c.

This standard does not apply to conduit systems, cable tray systems, cable ladder systems, power track systems or equipment covered by other standards.

Cable Trunking System (CTS)

Assembly comprising a **trunking length** and possibly other system components to provide an enclosure for the accommodation and laying in of insulated conductors and cables and possibly the accommodation of other electrical equipment.

Cable Ducting System (CDS)

Assembly comprising a **ducting length** and possibly other system components to provide an enclosure for the accommodation and drawing in of insulated conductors and cables and possibly the accommodation of other electrical equipment.

SYSTEM COMPONENT

Part of the system which includes :

a. Trunking length or ducting length,

c. Fixing device

e. System accessory



NOTE

A system does not necessarily include all system components a to e. Different combinations of system components may be used.

b. Trunking fitting or ducting fitting.

d. Apparatus mounting device.

TRUNKING LENGTH

Main component of a cable trunking system comprising a base with one or more access covers which may be opened or removed.

DUCTING LENGTH

Main component of a cable ducting system, characterized by a closed non-circular cross section.

FITTING

System component to connect, change direction or terminate trunking lengths or ducting lengths.

CLASSIFICATIONS

6.2 Resistance to impact for installation and application : **impact 2.0J**

6.3 According to temperatures as given in **tables 1, 2 & 3.**

Table 1 - Minimum storage and transport temperature

Minimum storage and transport temperature $\pm 2\text{ }^{\circ}\text{C}$
-45
-25
-15
-5

Table 2 - Minimum installation and application temperature

Minimum installation and application temperature $\pm 2\text{ }^{\circ}\text{C}$
-25
-15
-5
+5
+15

Table 3 - Maximum application temperature

Maximum Application temperature $\pm 2\text{ }^{\circ}\text{C}$
+60
+90
+105
+120



NOTE

The above application temperatures are operating temperatures and not ambient temperatures.



INSTALLATION & GUIDELINES

For each size of cable multiply the number to be installed by its own common factor. Add together the results of these calculations for all cable sizes. The resulting sum should be equal to or less than the trunking capacity. It is recommended that each compartment should not be filled over 45% of its full capacity.

COMMON cable factors

If the cable is not shown in the table below then the factor (area) can be calculated by:
Measuring diameter

Dividing diameter by 2 to give the radius Area = 3.142 x radius x radius. E.g



$$3.142 \times 2 \times 2 = 12.6 \text{ mm}^2$$

CABLE SIZE & FACTORS

Cable size & factors : Power		
Type	Conductor size mm ²	Factor
Solid	1.5	8
Solid	2.5	11.9
Stranded	1.5	8.6
Stranded	2.5	12.6
Stranded	4.0	16.6
Stranded	6.0	21.2
Stranded	10.0	35.3
Stranded	16.0	47.8
Stranded	25.0	73.9
Stranded	35.0	93.3
Stranded	50.0	128.7
Stranded	70.0	167.4
Stranded	95.0	229.7
Stranded	120.0	277.6
Stranded	150.0	343.1
Stranded	240.0	552.0

Cable size & factors : Data		
Type	Ø mm	Factor
5e UTP	5.5	30.2
5e STP	6.0	36.0
6 UTP	6.5	42.2
6 STP	7.0	49.0



CABLE TRUNKING CAPACITY GUIDE

For each size of cable, multiply the number to be installed by the common factor. Add together the results of these calculations for all cable sizes. The correct trunking size must have a capacity factor equal to or greater than this total.

TRUNKING SIZE & CAPACITY FACTORS



EXAMPLE



Trunking size & capacity factors	
Size (mm)	Capacity
50 x 50	1037
75 x 50	1555
75 x 75	2371
100 x 50	2091
100 x 75	3189
100 x 100	4252
150 x 50	3091
150 x 75	4742
150 x 100	6394
150 x 150	9697
225 x 75	7114
225 x 100	9298
225 x 150	14652
225 x 225	21766
300 x 75	9486
300 x 100	12788
300 x 150	19447
300 x 300	38000

Minimum Trunking size required in this case is $1864 + 238 = 2102$ which is 100 x 150.

SUPPORTING CABLE TRUNKING SYSTEMS

The connector between all types of cable trunking lengths is to provide electrical and mechanical connection between the lengths ; it does not provide a load bearing connection between lengths. Consequently each length must be fully secured to the wall so that there is no significant bending force applied to the connector.

TRUNKING BODY

The trunking body has fixing points every 500 mm and 250 mm from each end It is recommended to secure at least every metre and near to joints / ends Use washers and dome head screws or plastic caps to avoid damage to cables. Do not over tighten Fit trunking body to wall ensuring it is level with preceding length and that joints are closely butted together. Once secured, install earthing coupler to trunking joint by simply pushing into place ensuring that the coupler is evenly distributed over both parts .For best results when cutting, use a fine tooth circular saw Cut edges must be de-burred to avoid cable damage.

DIVIDERS

The trunking can be divided into two or three compartments. Dividers are supplied in any desired lengths and have rolled edges for safety.

ELECTROMAGNETIC COMPATIBILITY (EMC)

Cable trunking and duct systems are considered passive under normal conditions in respect of electromagnetic influences. The installation of current carrying cables may cause emissions and these cables may also be influenced by electromagnetic signals from elsewhere, but the degree of influence will depend on the nature of the installation and the apparatus connected to the system. Specific information relating to the details of cable separation required according to the type of signal, and further information on the subject of EMC, is provided in the relevant Standards and Regulations. However, as a basic principle, if power and data cables are run in separate compartments of a metal trunking system, then the metal segregation will significantly reduce the possibility of one circuit having an undesirable effect upon another.

FITTINGS

Fittings (e.g. bends, tees) are installed in the same manner as the trunking body

EARTHING

NIPRAS trunking system is designed with parts that provide earth continuity when installed.



شركة نبراس المعدن للصناعة
NIPRAS METAL INDUSTRY Co.



رؤية
VISION
2030
المملكة العربية السعودية
KINGDOM OF SAUDI ARABIA

CABLE TRUNK



NMG NIPRAS
METAL GROUP

SINGLE COMPARTMENT CABLE TRUNKING



Type 1: inside

Type 2: outside

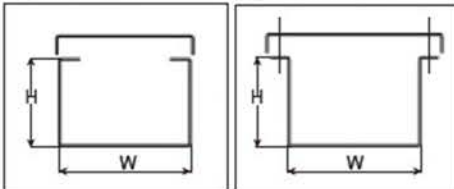

Available length & thickness
2440 mm / 3000 mm, Thickness 1.2-1.5 mm

Single Compartment Cable Trunking - Length - 2440 mm / 3000 mm					
Dimensions	Inch	Item Codes			
		Thickness 1 mm	Thickness 1.2 mm	Thickness 1.5 mm	Thickness 2 mm
50 x 50 mm	(2" x 2")	NCTR-1C-A	NCTR-1C-A1	NCTR-1C-A2	NCTR-1C-A3
75 x 50 mm	(3" x 2")	NCTR-1C-B	NCTR-1C-B1	NCTR-1C-B2	NCTR-1C-B3
75 x 75 mm	(3" x 3")	NCTR-1C-C	NCTR-1C-C1	NCTR-1C-C2	NCTR-1C-C3
100 x 50 mm	(4" x 2")	NCTR-1C-D	NCTR-1C-D1	NCTR-1C-D2	NCTR-1C-D3
100 x 75 mm	(4" x 3")	NCTR-1C-E	NCTR-1C-E1	NCTR-1C-E2	NCTR-1C-E3
100 x 100 mm	(4" x 4")	NCTR-1C-F	NCTR-1C-F1	NCTR-1C-F2	NCTR-1C-F3
150 x 50 mm	(6" x 2")	NCTR-1C-G	NCTR-1C-G1	NCTR-1C-G2	NCTR-1C-G3
150 x 75 mm	(6" x 3")	NCTR-1C-H	NCTR-1C-H1	NCTR-1C-H2	NCTR-1C-H3
150 x 100 mm	(6" x 4")	NCTR-1C-I	NCTR-1C-I1	NCTR-1C-I2	NCTR-1C-I3
150 x 150 mm	(6" x 6")	NCTR-1C-J	NCTR-1C-J1	NCTR-1C-J2	NCTR-1C-J3
200 x 100 mm	(8" x 4")	NCTR-1C-K	NCTR-1C-K1	NCTR-1C-K2	NCTR-1C-K3
300 x 100 mm	(12" x 4")	NCTR-1C-L	NCTR-1C-L1	NCTR-1C-L2	NCTR-1C-L3
450 x 100 mm	(18" x 4")	NCTR-1C-M	NCTR-1C-M1	NCTR-1C-M2	NCTR-1C-M3
600 x 100 mm	(24" x 4")	NCTR-1C-N	NCTR-1C-N1	NCTR-1C-N2	NCTR-1C-N3

DOUBLE COMPARTMENT CABLE TRUNKING

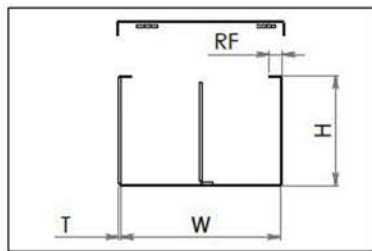
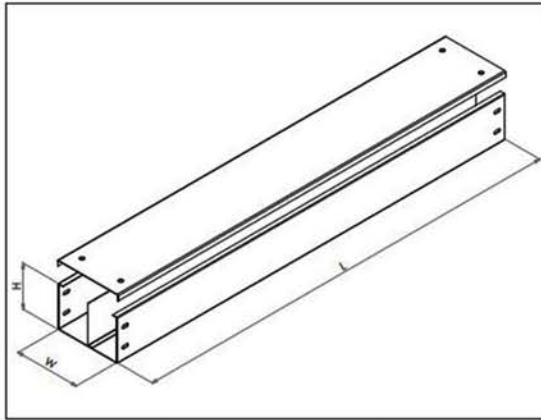

Available length & thickness
 2440 mm / 3000 mm, Thickness 1.2-1.5 mm

Double Compartment Cable Trunking - Length - 2440 mm / 3000 mm					
Dimensions	Inch	Item Codes			
		Thickness 1 mm	Thickness 1.2 mm	Thickness 1.5 mm	Thickness 2 mm
50 x 50 mm	(2" x 2")	NCTR-2C-A	NCTR-2C-A1	NCTR-2C-A2	NCTR-2C-A3
75 x 50 mm	(3" x 2")	NCTR-2C-B	NCTR-2C-B1	NCTR-2C-B2	NCTR-2C-B3
75 x 75 mm	(3" x 3")	NCTR-2C-C	NCTR-2C-C1	NCTR-2C-C2	NCTR-2C-C3
100 x 50 mm	(4" x 2")	NCTR-2C-D	NCTR-2C-D1	NCTR-2C-D2	NCTR-2C-D3
100 x 75 mm	(4" x 3")	NCTR-2C-E	NCTR-2C-E1	NCTR-2C-E2	NCTR-2C-E3
100 x 100 mm	(4" x 4")	NCTR-2C-F	NCTR-2C-F1	NCTR-2C-F2	NCTR-2C-F3
150 x 50 mm	(6" x 2")	NCTR-2C-G	NCTR-2C-G1	NCTR-2C-G2	NCTR-2C-G3
150 x 75 mm	(6" x 3")	NCTR-2C-H	NCTR-2C-H1	NCTR-2C-H2	NCTR-2C-H3
150 x 100 mm	(6" x 4")	NCTR-2C-I	NCTR-2C-I1	NCTR-2C-I2	NCTR-2C-I3
150 x 150 mm	(6" x 6")	NCTR-2C-J	NCTR-2C-J1	NCTR-2C-J2	NCTR-2C-J3
200 x 100 mm	(8" x 4")	NCTR-2C-K	NCTR-2C-K1	NCTR-2C-K2	NCTR-2C-K3
300 x 100 mm	(12" x 4")	NCTR-2C-L	NCTR-2C-L1	NCTR-2C-L2	NCTR-2C-L3
450 x 100 mm	(18" x 4")	NCTR-2C-M	NCTR-2C-M1	NCTR-2C-M2	NCTR-2C-M3
600 x 100 mm	(24" x 4")	NCTR-2C-N	NCTR-2C-N1	NCTR-2C-N2	NCTR-2C-N3

TRIPLE COMPARTMENT CABLE TRUNKING

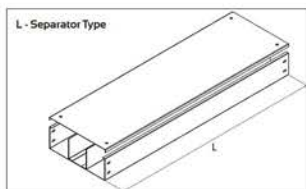
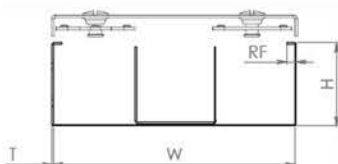
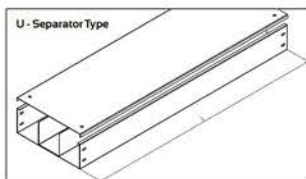
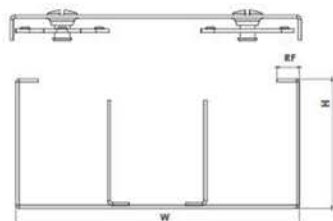

Triple Compartment Cable Trunking - Length - 2440 mm / 3000 mm

Dimensions	Inch	Item Codes			
		Thickness 1 mm	Thickness 1.2 mm	Thickness 1.5 mm	Thickness 2 mm
50 x 50 mm	(2" x 2")	NCTR-3C-A	NCTR-3C-A1	NCTR-3C-A2	NCTR-3C-A3
75 x 50 mm	(3" x 2")	NCTR-3C-B	NCTR-3C-B1	NCTR-3C-B2	NCTR-3C-B3
75 x 75 mm	(3" x 3")	NCTR-3C-C	NCTR-3C-C1	NCTR-3C-C2	NCTR-3C-C3
100 x 50 mm	(4" x 2")	NCTR-3C-D	NCTR-3C-D1	NCTR-3C-D2	NCTR-3C-D3
100 x 75 mm	(4" x 3")	NCTR-3C-E	NCTR-3C-E1	NCTR-3C-E2	NCTR-3C-E3
100 x 100 mm	(4" x 4")	NCTR-3C-F	NCTR-3C-F1	NCTR-3C-F2	NCTR-3C-F3
150 x 50 mm	(6" x 2")	NCTR-3C-G	NCTR-3C-G1	NCTR-3C-G2	NCTR-3C-G3
150 x 75 mm	(6" x 3")	NCTR-3C-H	NCTR-3C-H1	NCTR-3C-H2	NCTR-3C-H3
150 x 100 mm	(6" x 4")	NCTR-3C-I	NCTR-3C-I1	NCTR-3C-I2	NCTR-3C-I3
150 x 150 mm	(6" x 6")	NCTR-3C-J	NCTR-3C-J1	NCTR-3C-J2	NCTR-3C-J3
200 x 100 mm	(8" x 4")	NCTR-3C-K	NCTR-3C-K1	NCTR-3C-K2	NCTR-3C-K3
300 x 100 mm	(12" x 4")	NCTR-3C-L	NCTR-3C-L1	NCTR-3C-L2	NCTR-3C-L3
450 x 100 mm	(18" x 4")	NCTR-3C-M	NCTR-3C-M1	NCTR-3C-M2	NCTR-3C-M3
600 x 100 mm	(24" x 4")	NCTR-3C-N	NCTR-3C-N1	NCTR-3C-N2	NCTR-3C-N3



شركة نبراس المعدن للصناعة
NIPRAS METAL INDUSTRY Co.



رؤية
VISION
2030
المملكة العربية السعودية
KINGDOM OF SAUDI ARABIA

CABLE TRUNK FITTINGS.



NMG NIPRAS
METAL GROUP

BEND 45 ° TOP LID FOR SINGLE COMPARTMENT

Type 2: outside

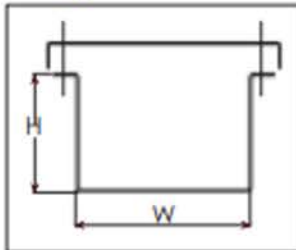

Type 1: inside

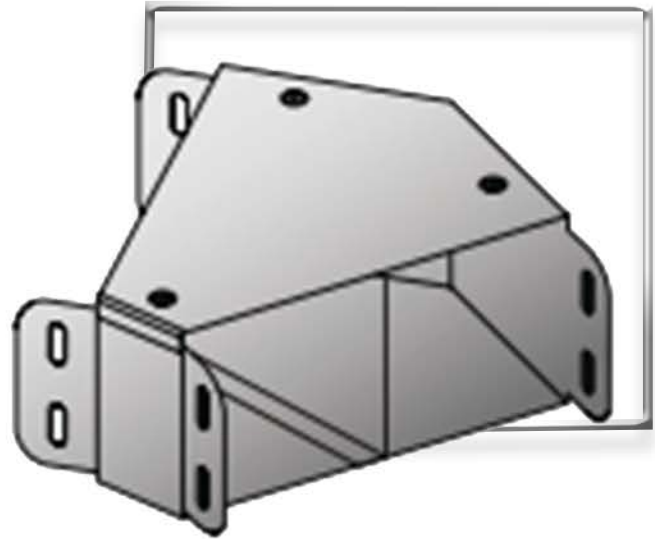
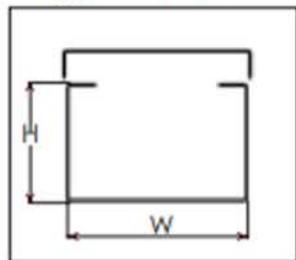

cornered / curved

Bend 45 ° Top Lid for Single Compartment

Dimensions	Inch	Item Codes			
		Thickness 1 mm	Thickness 1.2 mm	Thickness 1.5 mm	Thickness 2 mm
50 x 50 mm	(2" x 2")	NHB-45-T1-A	NHB-45-T1-A1	NHB-45-T1-A2	NHB-45-T1-A3
75 x 50 mm	(3" x 2")	NHB-45-T1-B	NHB-45-T1-B1	NHB-45-T1-B2	NHB-45-T1-B3
75 x 75 mm	(3" x 3")	NHB-45-T1-C	NHB-45-T1-C1	NHB-45-T1-C2	NHB-45-T1-C3
100 x 50 mm	(4" x 2")	NHB-45-T1-D	NHB-45-T1-D1	NHB-45-T1-D2	NHB-45-T1-D3
100 x 75 mm	(4" x 3")	NHB-45-T1-E	NHB-45-T1-E1	NHB-45-T1-E2	NHB-45-T1-E3
100 x 100 mm	(4" x 4")	NHB-45-T1-F	NHB-45-T1-F1	NHB-45-T1-F2	NHB-45-T1-F3
150 x 50 mm	(6" x 2")	NHB-45-T1-G	NHB-45-T1-G1	NHB-45-T1-G2	NHB-45-T1-G3
150 x 75 mm	(6" x 3")	NHB-45-T1-H	NHB-45-T1-H1	NHB-45-T1-H2	NHB-45-T1-H3
150 x 100 mm	(6" x 4")	NHB-45-T1-I	NHB-45-T1-I1	NHB-45-T1-I2	NHB-45-T1-I3
150 x 150 mm	(6" x 6")	NHB-45-T1-J	NHB-45-T1-J1	NHB-45-T1-J2	NHB-45-T1-J3
200 x 100 mm	(8" x 4")	NHB-45-T1-K	NHB-45-T1-K1	NHB-45-T1-K2	NHB-45-T1-K3
300 x 100 mm	(12" x 4")	NHB-45-T1-L	NHB-45-T1-L1	NHB-45-T1-L2	NHB-45-T1-L3
450 x 100 mm	(18" x 4")	NHB-45-T1-M	NHB-45-T1-M1	NHB-45-T1-M2	NHB-45-T1-M3
600 x 100 mm	(24" x 4")	NHB-45-T1-N	NHB-45-T1-N1	NHB-45-T1-N2	NHB-45-T1-N3

BEND 45 ° TOP LID FOR DOUBLE COMPARTMENT

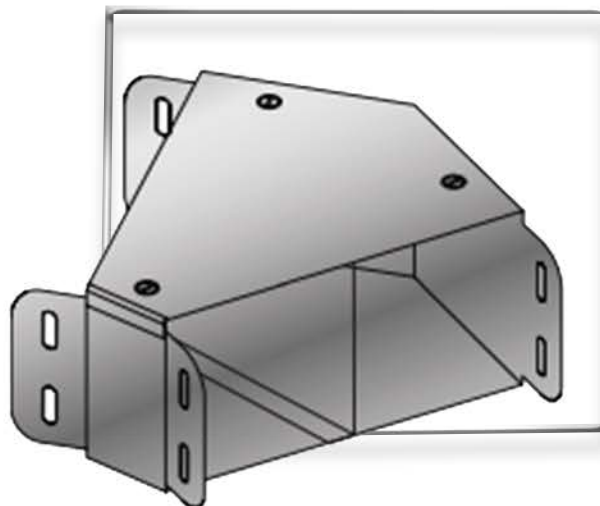

cornered / curved

Bend 45 ° Top Lid for Double Compartment					
Dimensions	Inch	Item Codes			
		Thickness 1 mm	Thickness 1.2 mm	Thickness 1.5 mm	Thickness 2 mm
50 x 50 mm	(2" x 2")	NHB-45-T2-A	NHB-45-T2-A1	NHB-45-T2-A2	NHB-45-T2-A3
75 x 50 mm	(3" x 2")	NHB-45-T2-B	NHB-45-T2-B1	NHB-45-T2-B2	NHB-45-T2-B3
75 x 75 mm	(3" x 3")	NHB-45-T2-C	NHB-45-T2-C1	NHB-45-T2-C2	NHB-45-T2-C3
100 x 50 mm	(4" x 2")	NHB-45-T2-D	NHB-45-T2-D1	NHB-45-T2-D2	NHB-45-T2-D3
100 x 75 mm	(4" x 3")	NHB-45-T2-E	NHB-45-T2-E1	NHB-45-T2-E2	NHB-45-T2-E3
100 x 100 mm	(4" x 4")	NHB-45-T2-F	NHB-45-T2-F1	NHB-45-T2-F2	NHB-45-T2-F3
150 x 50 mm	(6" x 2")	NHB-45-T2-G	NHB-45-T2-G1	NHB-45-T2-G2	NHB-45-T2-G3
150 x 75 mm	(6" x 3")	NHB-45-T2-H	NHB-45-T2-H1	NHB-45-T2-H2	NHB-45-T2-H3
150 x 100 mm	(6" x 4")	NHB-45-T2-I	NHB-45-T2-I1	NHB-45-T2-I2	NHB-45-T2-I3
150 x 150 mm	(6" x 6")	NHB-45-T2-J	NHB-45-T2-J1	NHB-45-T2-J2	NHB-45-T2-J3
200 x 100 mm	(8" x 4")	NHB-45-T2-K	NHB-45-T2-K1	NHB-45-T2-K2	NHB-45-T2-K3
300 x 100 mm	(12" x 4")	NHB-45-T2-L	NHB-45-T2-L1	NHB-45-T2-L2	NHB-45-T2-L3
450 x 100 mm	(18" x 4")	NHB-45-T2-M	NHB-45-T2-M1	NHB-45-T2-M2	NHB-45-T2-M3
600 x 100 mm	(24" x 4")	NHB-45-T2-N	NHB-45-T2-N1	NHB-45-T2-N2	NHB-45-T2-N3

BEND 45 ° TOP LID FOR TRIPLE COMPARTMENT

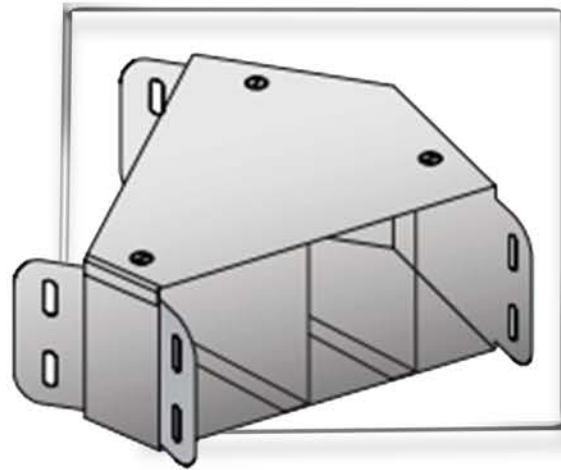

cornered / curved

Bend 45 ° Top Lid for Triple Compartment					
Dimensions	Inch	Item Codes			
		Thickness 1 mm	Thickness 1.2 mm	Thickness 1.5 mm	Thickness 2 mm
50 x 50 mm	(2" x 2")	NHB-45-T3-A	NHB-45-T3-A1	NHB-45-T3-A2	NHB-45-T3-A3
75 x 50 mm	(3" x 2")	NHB-45-T3-B	NHB-45-T3-B1	NHB-45-T3-B2	NHB-45-T3-B3
75 x 75 mm	(3" x 3")	NHB-45-T3-C	NHB-45-T3-C1	NHB-45-T3-C2	NHB-45-T3-C3
100 x 50 mm	(4" x 2")	NHB-45-T3-D	NHB-45-T3-D1	NHB-45-T3-D2	NHB-45-T3-D3
100 x 75 mm	(4" x 3")	NHB-45-T3-E	NHB-45-T3-E1	NHB-45-T3-E2	NHB-45-T3-E3
100 x 100 mm	(4" x 4")	NHB-45-T3-F	NHB-45-T3-F1	NHB-45-T3-F2	NHB-45-T3-F3
150 x 50 mm	(6" x 2")	NHB-45-T3-G	NHB-45-T3-G1	NHB-45-T3-G2	NHB-45-T3-G3
150 x 75 mm	(6" x 3")	NHB-45-T3-H	NHB-45-T3-H1	NHB-45-T3-H2	NHB-45-T3-H3
150 x 100 mm	(6" x 4")	NHB-45-T3-I	NHB-45-T3-I1	NHB-45-T3-I2	NHB-45-T3-I3
150 x 150 mm	(6" x 6")	NHB-45-T3-J	NHB-45-T3-J1	NHB-45-T3-J2	NHB-45-T3-J3
200 x 100 mm	(8" x 4")	NHB-45-T3-K	NHB-45-T3-K1	NHB-45-T3-K2	NHB-45-T3-K3
300 x 100 mm	(12" x 4")	NHB-45-T3-L	NHB-45-T3-L1	NHB-45-T3-L2	NHB-45-T3-L3
450 x 100 mm	(18" x 4")	NHB-45-T3-M	NHB-45-T3-M1	NHB-45-T3-M2	NHB-45-T3-M3
600 x 100 mm	(24" x 4")	NHB-45-T3-N	NHB-45-T3-N1	NHB-45-T3-N2	NHB-45-T3-N3

BEND 45 ° INSIDE LID FOR SINGLE COMPARTMENT



Type 2: outside

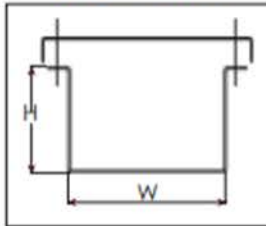

Type 1: inside

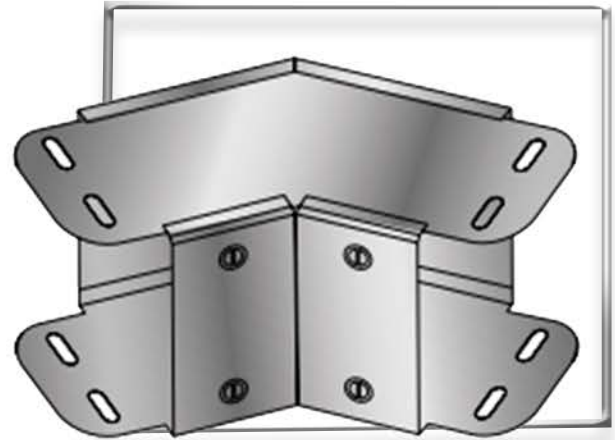
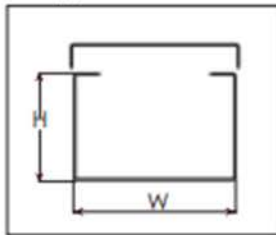

cornered / curved

Bend 45 ° Inside Lid for Single Compartment

Dimensions	Inch	Item Codes			
		Thickness 1 mm	Thickness 1.2 mm	Thickness 1.5 mm	Thickness 2 mm
50 x 50 mm	(2" x 2")	NHB-45-I1-A	NHB-45-I1-A1	NHB-45-I1-A2	NHB-45-I1-A3
75 x 50 mm	(3" x 2")	NHB-45-I1-B	NHB-45-I1-B1	NHB-45-I1-B2	NHB-45-I1-B3
75 x 75 mm	(3" x 3")	NHB-45-I1-C	NHB-45-I1-C1	NHB-45-I1-C2	NHB-45-I1-C3
100 x 50 mm	(4" x 2")	NHB-45-I1-D	NHB-45-I1-D1	NHB-45-I1-D2	NHB-45-I1-D3
100 x 75 mm	(4" x 3")	NHB-45-I1-E	NHB-45-I1-E1	NHB-45-I1-E2	NHB-45-I1-E3
100 x 100 mm	(4" x 4")	NHB-45-I1-F	NHB-45-I1-F1	NHB-45-I1-F2	NHB-45-I1-F3
150 x 50 mm	(6" x 2")	NHB-45-I1-G	NHB-45-I1-G1	NHB-45-I1-G2	NHB-45-I1-G3
150 x 75 mm	(6" x 3")	NHB-45-I1-H	NHB-45-I1-H1	NHB-45-I1-H2	NHB-45-I1-H3
150 x 100 mm	(6" x 4")	NHB-45-I1-I	NHB-45-I1-I1	NHB-45-I1-I2	NHB-45-I1-I3
150 x 150 mm	(6" x 6")	NHB-45-I1-J	NHB-45-I1-J1	NHB-45-I1-J2	NHB-45-I1-J3
200 x 100 mm	(8" x 4")	NHB-45-I1-K	NHB-45-I1-K1	NHB-45-I1-K2	NHB-45-I1-K3
300 x 100 mm	(12" x 4")	NHB-45-I1-L	NHB-45-I1-L1	NHB-45-I1-L2	NHB-45-I1-L3
450 x 100 mm	(18" x 4")	NHB-45-I1-M	NHB-45-I1-M1	NHB-45-I1-M2	NHB-45-I1-M3
600 x 100 mm	(24" x 4")	NHB-45-I1-N	NHB-45-I1-N1	NHB-45-I1-N2	NHB-45-I1-N3

BEND 45 ° INSIDE LID FOR DOUBLE COMPARTMENT

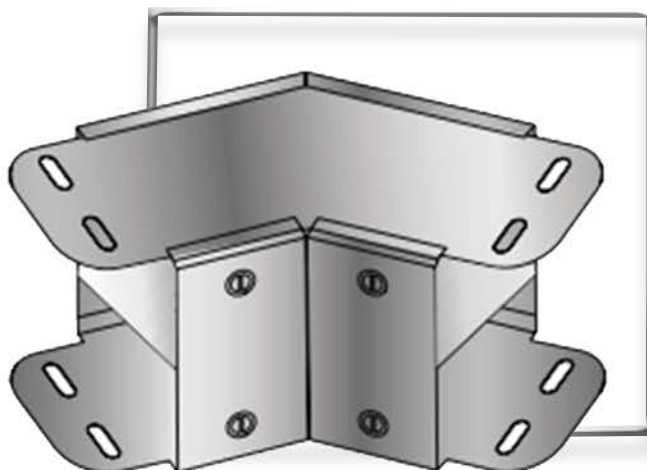

cornered / curved

Bend 45 ° Inside Lid for Double Compartment					
Dimensions	Inch	Item Codes			
		Thickness 1 mm	Thickness 1.2 mm	Thickness 1.5 mm	Thickness 2 mm
50 x 50 mm	(2" x 2")	NHB-45-I2-A	NHB-45-I2-A1	NHB-45-I2-A2	NHB-45-I2-A3
75 x 50 mm	(3" x 2")	NHB-45-I2-B	NHB-45-I2-B1	NHB-45-I2-B2	NHB-45-I2-B3
75 x 75 mm	(3" x 3")	NHB-45-I2-C	NHB-45-I2-C1	NHB-45-I2-C2	NHB-45-I2-C3
100 x 50 mm	(4" x 2")	NHB-45-I2-D	NHB-45-I2-D1	NHB-45-I2-D2	NHB-45-I2-D3
100 x 75 mm	(4" x 3")	NHB-45-I2-E	NHB-45-I2-E1	NHB-45-I2-E2	NHB-45-I2-E3
100 x 100 mm	(4" x 4")	NHB-45-I2-F	NHB-45-I2-F1	NHB-45-I2-F2	NHB-45-I2-F3
150 x 50 mm	(6" x 2")	NHB-45-I2-G	NHB-45-I2-G1	NHB-45-I2-G2	NHB-45-I2-G3
150 x 75 mm	(6" x 3")	NHB-45-I2-H	NHB-45-I2-H1	NHB-45-I2-H2	NHB-45-I2-H3
150 x 100 mm	(6" x 4")	NHB-45-I2-I	NHB-45-I2-I1	NHB-45-I2-I2	NHB-45-I2-I3
150 x 150 mm	(6" x 6")	NHB-45-I2-J	NHB-45-I2-J1	NHB-45-I2-J2	NHB-45-I2-J3
200 x 100 mm	(8" x 4")	NHB-45-I2-K	NHB-45-I2-K1	NHB-45-I2-K2	NHB-45-I2-K3
300 x 100 mm	(12" x 4")	NHB-45-I2-L	NHB-45-I2-L1	NHB-45-I2-L2	NHB-45-I2-L3
450 x 100 mm	(18" x 4")	NHB-45-I2-M	NHB-45-I2-M1	NHB-45-I2-M2	NHB-45-I2-M3
600 x 100 mm	(24" x 4")	NHB-45-I2-N	NHB-45-I2-N1	NHB-45-I2-N2	NHB-45-I2-N3

BEND 45 ° INSIDE LID FOR TRIPLE COMPARTMENT

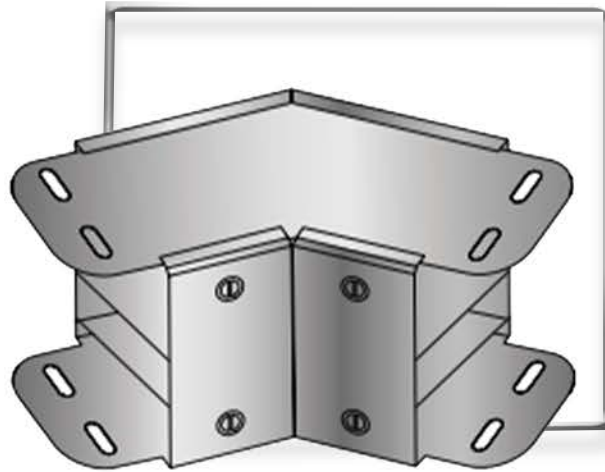

cornered / curved

Bend 45 ° Inside Lid for Triple Compartment					
Dimensions	Inch	Item Codes			
		Thickness 1 mm	Thickness 1.2 mm	Thickness 1.5 mm	Thickness 2 mm
50 x 50 mm	(2" x 2")	NHB-45-I3-A	NHB-45-I3-A1	NHB-45-I3-A2	NHB-45-I3-A3
75 x 50 mm	(3" x 2")	NHB-45-I3-B	NHB-45-I3-B1	NHB-45-I3-B2	NHB-45-I3-B3
75 x 75 mm	(3" x 3")	NHB-45-I3-C	NHB-45-I3-C1	NHB-45-I3-C2	NHB-45-I3-C3
100 x 50 mm	(4" x 2")	NHB-45-I3-D	NHB-45-I3-D1	NHB-45-I3-D2	NHB-45-I3-D3
100 x 75 mm	(4" x 3")	NHB-45-I3-E	NHB-45-I3-E1	NHB-45-I3-E2	NHB-45-I3-E3
100 x 100 mm	(4" x 4")	NHB-45-I3-F	NHB-45-I3-F1	NHB-45-I3-F2	NHB-45-I3-F3
150 x 50 mm	(6" x 2")	NHB-45-I3-G	NHB-45-I3-G1	NHB-45-I3-G2	NHB-45-I3-G3
150 x 75 mm	(6" x 3")	NHB-45-I3-H	NHB-45-I3-H1	NHB-45-I3-H2	NHB-45-I3-H3
150 x 100 mm	(6" x 4")	NHB-45-I3-I	NHB-45-I3-I1	NHB-45-I3-I2	NHB-45-I3-I3
150 x 150 mm	(6" x 6")	NHB-45-I3-J	NHB-45-I3-J1	NHB-45-I3-J2	NHB-45-I3-J3
200 x 100 mm	(8" x 4")	NHB-45-I3-K	NHB-45-I3-K1	NHB-45-I3-K2	NHB-45-I3-K3
300 x 100 mm	(12" x 4")	NHB-45-I3-L	NHB-45-I3-L1	NHB-45-I3-L2	NHB-45-I3-L3
450 x 100 mm	(18" x 4")	NHB-45-I3-M	NHB-45-I3-M1	NHB-45-I3-M2	NHB-45-I3-M3
600 x 100 mm	(24" x 4")	NHB-45-I3-N	NHB-45-I3-N1	NHB-45-I3-N2	NHB-45-I3-N3

BEND 45 ° OUTSIDE LID FOR SINGLE COMPARTMENT



Type 1: inside

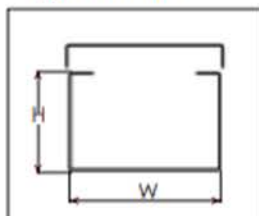

Type 2: outside

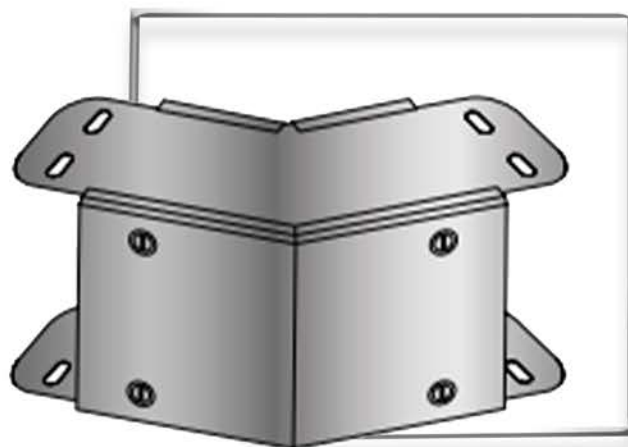
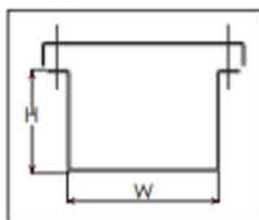

cornered / curved

Bend 45 ° Outside Lid for Single Compartment

Dimensions	Inch	Item Codes			
		Thickness 1 mm	Thickness 1.2 mm	Thickness 1.5 mm	Thickness 2 mm
50 x 50 mm	(2" x 2")	NHB-45-01-A	NHB-45-01-A1	NHB-45-01-A2	NHB-45-01-A3
75 x 50 mm	(3" x 2")	NHB-45-01-B	NHB-45-01-B1	NHB-45-01-B2	NHB-45-01-B3
75 x 75 mm	(3" x 3")	NHB-45-01-C	NHB-45-01-C1	NHB-45-01-C2	NHB-45-01-C3
100 x 50 mm	(4" x 2")	NHB-45-01-D	NHB-45-01-D1	NHB-45-01-D2	NHB-45-01-D3
100 x 75 mm	(4" x 3")	NHB-45-01-E	NHB-45-01-E1	NHB-45-01-E2	NHB-45-01-E3
100 x 100 mm	(4" x 4")	NHB-45-01-F	NHB-45-01-F1	NHB-45-01-F2	NHB-45-01-F3
150 x 50 mm	(6" x 2")	NHB-45-01-G	NHB-45-01-G1	NHB-45-01-G2	NHB-45-01-G3
150 x 75 mm	(6" x 3")	NHB-45-01-H	NHB-45-01-H1	NHB-45-01-H2	NHB-45-01-H3
150 x 100 mm	(6" x 4")	NHB-45-01-I	NHB-45-01-I1	NHB-45-01-I2	NHB-45-01-I3
150 x 150 mm	(6" x 6")	NHB-45-01-J	NHB-45-01-J1	NHB-45-01-J2	NHB-45-01-J3
200 x 100 mm	(8" x 4")	NHB-45-01-K	NHB-45-01-K1	NHB-45-01-K2	NHB-45-01-K3
300 x 100 mm	(12" x 4")	NHB-45-01-L	NHB-45-01-L1	NHB-45-01-L2	NHB-45-01-L3
450 x 100 mm	(18" x 4")	NHB-45-01-M	NHB-45-01-M1	NHB-45-01-M2	NHB-45-01-M3
600 x 100 mm	(24" x 4")	NHB-45-01-N	NHB-45-01-N1	NHB-45-01-N2	NHB-45-01-N3

BEND 45 ° OUTSIDE LID FOR DOUBLE COMPARTMENT

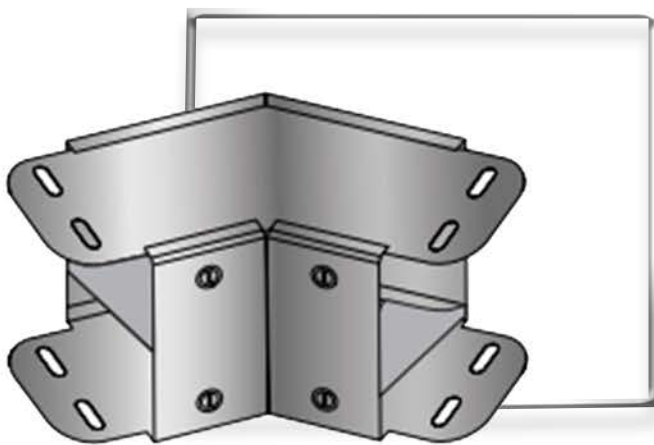

cornered / curved

Bend 45 ° Outside Lid for Double Compartment					
Dimensions	Inch	Item Codes			
		Thickness 1 mm	Thickness 1.2 mm	Thickness 1.5 mm	Thickness 2 mm
50 x 50 mm	(2" x 2")	NHB-45-O2-A	NHB-45-O2-A1	NHB-45-O2-A2	NHB-45-O2-A3
75 x 50 mm	(3" x 2")	NHB-45-O2-B	NHB-45-O2-B1	NHB-45-O2-B2	NHB-45-O2-B3
75 x 75 mm	(3" x 3")	NHB-45-O2-C	NHB-45-O2-C1	NHB-45-O2-C2	NHB-45-O2-C3
100 x 50 mm	(4" x 2")	NHB-45-O2-D	NHB-45-O2-D1	NHB-45-O2-D2	NHB-45-O2-D3
100 x 75 mm	(4" x 3")	NHB-45-O2-E	NHB-45-O2-E1	NHB-45-O2-E2	NHB-45-O2-E3
100 x 100 mm	(4" x 4")	NHB-45-O2-F	NHB-45-O2-F1	NHB-45-O2-F2	NHB-45-O2-F3
150 x 50 mm	(6" x 2")	NHB-45-O2-G	NHB-45-O2-G1	NHB-45-O2-G2	NHB-45-O2-G3
150 x 75 mm	(6" x 3")	NHB-45-O2-H	NHB-45-O2-H1	NHB-45-O2-H2	NHB-45-O2-H3
150 x 100 mm	(6" x 4")	NHB-45-O2-I	NHB-45-O2-I1	NHB-45-O2-I2	NHB-45-O2-I3
150 x 150 mm	(6" x 6")	NHB-45-O2-J	NHB-45-O2-J1	NHB-45-O2-J2	NHB-45-O2-J3
200 x 100 mm	(8" x 4")	NHB-45-O2-K	NHB-45-O2-K1	NHB-45-O2-K2	NHB-45-O2-K3
300 x 100 mm	(12" x 4")	NHB-45-O2-L	NHB-45-O2-L1	NHB-45-O2-L2	NHB-45-O2-L3
450 x 100 mm	(18" x 4")	NHB-45-O2-M	NHB-45-O2-M1	NHB-45-O2-M2	NHB-45-O2-M3
600 x 100 mm	(24" x 4")	NHB-45-O2-N	NHB-45-O2-N1	NHB-45-O2-N2	NHB-45-O2-N3

BEND 45 ° OUTSIDE LID FOR TRIPLE COMPARTMENT

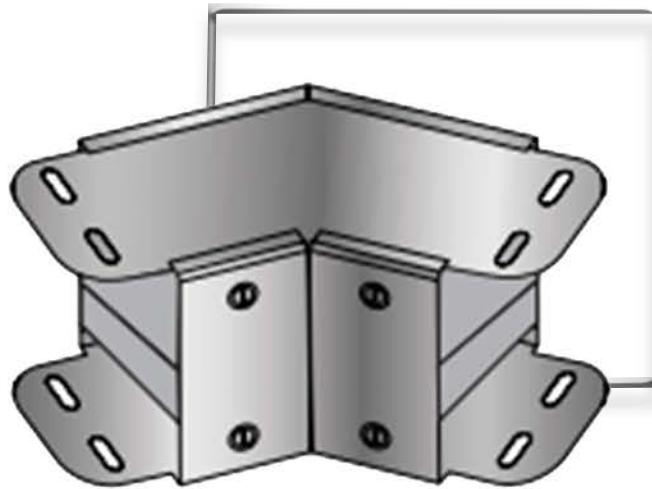

cornered / curved

Bend 45 ° Outside Lid for Triple Compartment					
Dimensions	Inch	Item Codes			
		Thickness 1 mm	Thickness 1.2 mm	Thickness 1.5 mm	Thickness 2 mm
50 x 50 mm	(2" x 2")	NHB-45-03-A	NHB-45-03-A1	NHB-45-03-A2	NHB-45-03-A3
75 x 50 mm	(3" x 2")	NHB-45-03-B	NHB-45-03-B1	NHB-45-03-B2	NHB-45-03-B3
75 x 75 mm	(3" x 3")	NHB-45-03-C	NHB-45-03-C1	NHB-45-03-C2	NHB-45-03-C3
100 x 50 mm	(4" x 2")	NHB-45-03-D	NHB-45-03-D1	NHB-45-03-D2	NHB-45-03-D3
100 x 75 mm	(4" x 3")	NHB-45-03-E	NHB-45-03-E1	NHB-45-03-E2	NHB-45-03-E3
100 x 100 mm	(4" x 4")	NHB-45-03-F	NHB-45-03-F1	NHB-45-03-F2	NHB-45-03-F3
150 x 50 mm	(6" x 2")	NHB-45-03-G	NHB-45-03-G1	NHB-45-03-G2	NHB-45-03-G3
150 x 75 mm	(6" x 3")	NHB-45-03-H	NHB-45-03-H1	NHB-45-03-H2	NHB-45-03-H3
150 x 100 mm	(6" x 4")	NHB-45-03-I	NHB-45-03-I1	NHB-45-03-I2	NHB-45-03-I3
150 x 150 mm	(6" x 6")	NHB-45-03-J	NHB-45-03-J1	NHB-45-03-J2	NHB-45-03-J3
200 x 100 mm	(8" x 4")	NHB-45-03-K	NHB-45-03-K1	NHB-45-03-K2	NHB-45-03-K3
300 x 100 mm	(12" x 4")	NHB-45-03-L	NHB-45-03-L1	NHB-45-03-L2	NHB-45-03-L3
450 x 100 mm	(18" x 4")	NHB-45-03-M	NHB-45-03-M1	NHB-45-03-M2	NHB-45-03-M3
600 x 100 mm	(24" x 4")	NHB-45-03-N	NHB-45-03-N1	NHB-45-03-N2	NHB-45-03-N3

BEND 90 ° TOP LID FOR SINGLE COMPARTMENT



Type 1: inside

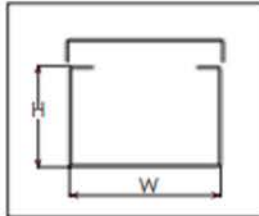

Type 2: outside

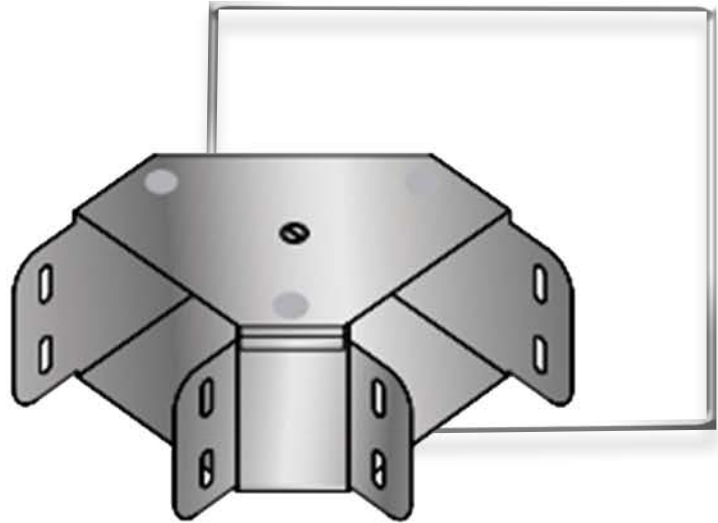
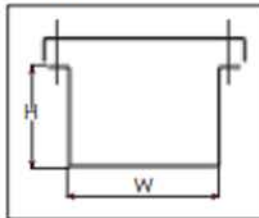

cornered / curved

Bend 90° Top Lid for Single Compartment

Dimensions	Inch	Item Codes			
		Thickness 1 mm	Thickness 1.2 mm	Thickness 1.5 mm	Thickness 2 mm
50 x 50 mm	(2" x 2")	NHB-90-T1-A	NHB-90-T1-A1	NHB-90-T1-A2	NHB-90-T1-A3
75 x 50 mm	(3" x 2")	NHB-90-T1-B	NHB-90-T1-B1	NHB-90-T1-B2	NHB-90-T1-B3
75 x 75 mm	(3" x 3")	NHB-90-T1-C	NHB-90-T1-C1	NHB-90-T1-C2	NHB-90-T1-C3
100 x 50 mm	(4" x 2")	NHB-90-T1-D	NHB-90-T1-D1	NHB-90-T1-D2	NHB-90-T1-D3
100 x 75 mm	(4" x 3")	NHB-90-T1-E	NHB-90-T1-E1	NHB-90-T1-E2	NHB-90-T1-E3
100 x 100 mm	(4" x 4")	NHB-90-T1-F	NHB-90-T1-F1	NHB-90-T1-F2	NHB-90-T1-F3
150 x 50 mm	(6" x 2")	NHB-90-T1-G	NHB-90-T1-G1	NHB-90-T1-G2	NHB-90-T1-G3
150 x 75 mm	(6" x 3")	NHB-90-T1-H	NHB-90-T1-H1	NHB-90-T1-H2	NHB-90-T1-H3
150 x 100 mm	(6" x 4")	NHB-90-T1-I	NHB-90-T1-I1	NHB-90-T1-I2	NHB-90-T1-I3
150 x 150 mm	(6" x 6")	NHB-90-T1-J	NHB-90-T1-J1	NHB-90-T1-J2	NHB-90-T1-J3
200 x 100 mm	(8" x 4")	NHB-90-T1-K	NHB-90-T1-K1	NHB-90-T1-K2	NHB-90-T1-K3
300 x 100 mm	(12" x 4")	NHB-90-T1-L	NHB-90-T1-L1	NHB-90-T1-L2	NHB-90-T1-L3
450 x 100 mm	(18" x 4")	NHB-90-T1-M	NHB-90-T1-M1	NHB-90-T1-M2	NHB-90-T1-M3
600 x 100 mm	(24" x 4")	NHB-90-T1-N	NHB-90-T1-N1	NHB-90-T1-N2	NHB-90-T1-N3

BEND 90 ° TOP LID FOR DOUBLE COMPARTMENT

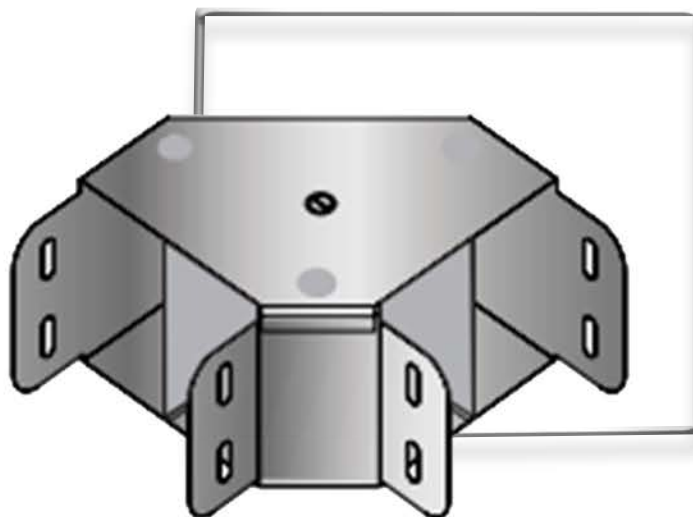

cornered / curved

Bend 90° Top Lid for Double Compartment					
Dimensions	Inch	Item Codes			
		Thickness 1 mm	Thickness 1.2 mm	Thickness 1.5 mm	Thickness 2 mm
50 x 50 mm	(2" x 2")	NHB-90-T2-A	NHB-90-T2-A1	NHB-90-T2-A2	NHB-90-T2-A3
75 x 50 mm	(3" x 2")	NHB-90-T2-B	NHB-90-T2-B1	NHB-90-T2-B2	NHB-90-T2-B3
75 x 75 mm	(3" x 3")	NHB-90-T2-C	NHB-90-T2-C1	NHB-90-T2-C2	NHB-90-T2-C3
100 x 50 mm	(4" x 2")	NHB-90-T2-D	NHB-90-T2-D1	NHB-90-T2-D2	NHB-90-T2-D3
100 x 75 mm	(4" x 3")	NHB-90-T2-E	NHB-90-T2-E1	NHB-90-T2-E2	NHB-90-T2-E3
100 x 100 mm	(4" x 4")	NHB-90-T2-F	NHB-90-T2-F1	NHB-90-T2-F2	NHB-90-T2-F3
150 x 50 mm	(6" x 2")	NHB-90-T2-G	NHB-90-T2-G1	NHB-90-T2-G2	NHB-90-T2-G3
150 x 75 mm	(6" x 3")	NHB-90-T2-H	NHB-90-T2-H1	NHB-90-T2-H2	NHB-90-T2-H3
150 x 100 mm	(6" x 4")	NHB-90-T2-I	NHB-90-T2-I1	NHB-90-T2-I2	NHB-90-T2-I3
150 x 150 mm	(6" x 6")	NHB-90-T2-J	NHB-90-T2-J1	NHB-90-T2-J2	NHB-90-T2-J3
200 x 100 mm	(8" x 4")	NHB-90-T2-K	NHB-90-T2-K1	NHB-90-T2-K2	NHB-90-T2-K3
300 x 100 mm	(12" x 4")	NHB-90-T2-L	NHB-90-T2-L1	NHB-90-T2-L2	NHB-90-T2-L3
450 x 100 mm	(18" x 4")	NHB-90-T2-M	NHB-90-T2-M1	NHB-90-T2-M2	NHB-90-T2-M3
600 x 100 mm	(24" x 4")	NHB-90-T2-N	NHB-90-T2-N1	NHB-90-T2-N2	NHB-90-T2-N3

BEND 90 ° TOP LID FOR TRIPLE COMPARTMENT

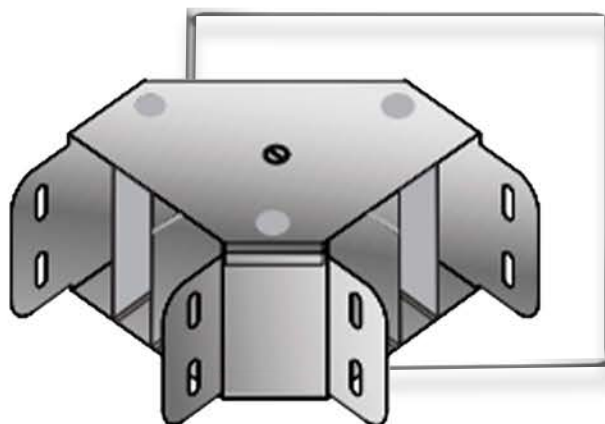

cornered / curved

Bend 90° Top Lid for Triple Compartment					
Dimensions	Inch	Item Codes			
		Thickness 1 mm	Thickness 1.2 mm	Thickness 1.5 mm	Thickness 2 mm
50 x 50 mm	(2" x 2")	NHB-90-T3-A	NHB-90-T3-A1	NHB-90-T3-A2	NHB-90-T3-A3
75 x 50 mm	(3" x 2")	NHB-90-T3-B	NHB-90-T3-B1	NHB-90-T3-B2	NHB-90-T3-B3
75 x 75 mm	(3" x 3")	NHB-90-T3-C	NHB-90-T3-C1	NHB-90-T3-C2	NHB-90-T3-C3
100 x 50 mm	(4" x 2")	NHB-90-T3-D	NHB-90-T3-D1	NHB-90-T3-D2	NHB-90-T3-D3
100 x 75 mm	(4" x 3")	NHB-90-T3-E	NHB-90-T3-E1	NHB-90-T3-E2	NHB-90-T3-E3
100 x 100 mm	(4" x 4")	NHB-90-T3-F	NHB-90-T3-F1	NHB-90-T3-F2	NHB-90-T3-F3
150 x 50 mm	(6" x 2")	NHB-90-T3-G	NHB-90-T3-G1	NHB-90-T3-G2	NHB-90-T3-G3
150 x 75 mm	(6" x 3")	NHB-90-T3-H	NHB-90-T3-H1	NHB-90-T3-H2	NHB-90-T3-H3
150 x 100 mm	(6" x 4")	NHB-90-T3-I	NHB-90-T3-I1	NHB-90-T3-I2	NHB-90-T3-I3
150 x 150 mm	(6" x 6")	NHB-90-T3-J	NHB-90-T3-J1	NHB-90-T3-J2	NHB-90-T3-J3
200 x 100 mm	(8" x 4")	NHB-90-T3-K	NHB-90-T3-K1	NHB-90-T3-K2	NHB-90-T3-K3
300 x 100 mm	(12" x 4")	NHB-90-T3-L	NHB-90-T3-L1	NHB-90-T3-L2	NHB-90-T3-L3
450 x 100 mm	(18" x 4")	NHB-90-T3-M	NHB-90-T3-M1	NHB-90-T3-M2	NHB-90-T3-M3
600 x 100 mm	(24" x 4")	NHB-90-T3-N	NHB-90-T3-N1	NHB-90-T3-N2	NHB-90-T3-N3

BEND 90 ° INSIDE LID FOR SINGLE COMPARTMENT



Type 1: inside

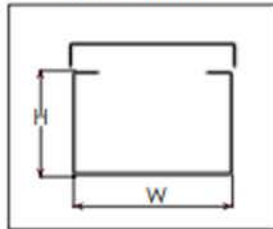

Type 2: outside

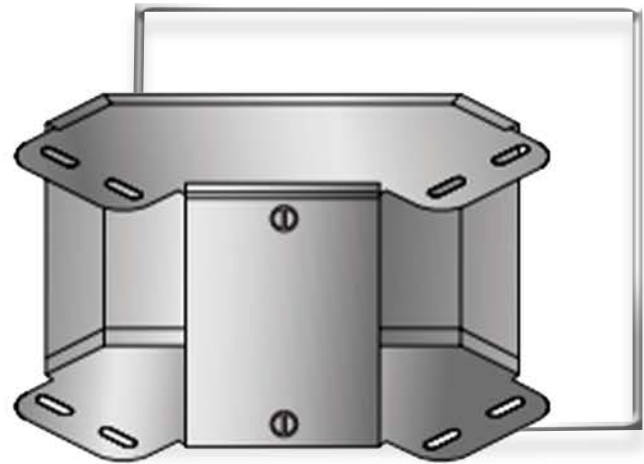
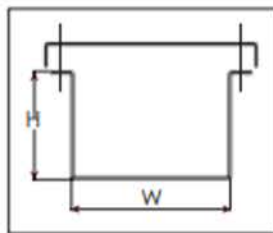

cornered / curved

Bend 90° Inside Lid for Single Compartment

Dimensions	Inch	Item Codes			
		Thickness 1 mm	Thickness 1.2 mm	Thickness 1.5 mm	Thickness 2 mm
50 x 50 mm	(2" x 2")	NHB-90-I1-A	NHB-90-I1-A1	NHB-90-I1-A2	NHB-90-I1-A3
75 x 50 mm	(3" x 2")	NHB-90-I1-B	NHB-90-I1-B1	NHB-90-I1-B2	NHB-90-I1-B3
75 x 75 mm	(3" x 3")	NHB-90-I1-C	NHB-90-I1-C1	NHB-90-I1-C2	NHB-90-I1-C3
100 x 50 mm	(4" x 2")	NHB-90-I1-D	NHB-90-I1-D1	NHB-90-I1-D2	NHB-90-I1-D3
100 x 75 mm	(4" x 3")	NHB-90-I1-E	NHB-90-I1-E1	NHB-90-I1-E2	NHB-90-I1-E3
100 x 100 mm	(4" x 4")	NHB-90-I1-F	NHB-90-I1-F1	NHB-90-I1-F2	NHB-90-I1-F3
150 x 50 mm	(6" x 2")	NHB-90-I1-G	NHB-90-I1-G1	NHB-90-I1-G2	NHB-90-I1-G3
150 x 75 mm	(6" x 3")	NHB-90-I1-H	NHB-90-I1-H1	NHB-90-I1-H2	NHB-90-I1-H3
150 x 100 mm	(6" x 4")	NHB-90-I1-I	NHB-90-I1-I1	NHB-90-I1-I2	NHB-90-I1-I3
150 x 150 mm	(6" x 6")	NHB-90-I1-J	NHB-90-I1-J1	NHB-90-I1-J2	NHB-90-I1-J3
200 x 100 mm	(8" x 4")	NHB-90-I1-K	NHB-90-I1-K1	NHB-90-I1-K2	NHB-90-I1-K3
300 x 100 mm	(12" x 4")	NHB-90-I1-L	NHB-90-I1-L1	NHB-90-I1-L2	NHB-90-I1-L3
450 x 100 mm	(18" x 4")	NHB-90-I1-M	NHB-90-I1-M1	NHB-90-I1-M2	NHB-90-I1-M3
600 x 100 mm	(24" x 4")	NHB-90-I1-N	NHB-90-I1-N1	NHB-90-I1-N2	NHB-90-I1-N3

BEND 90 ° INSIDE LID FOR DOUBLE COMPARTMENT

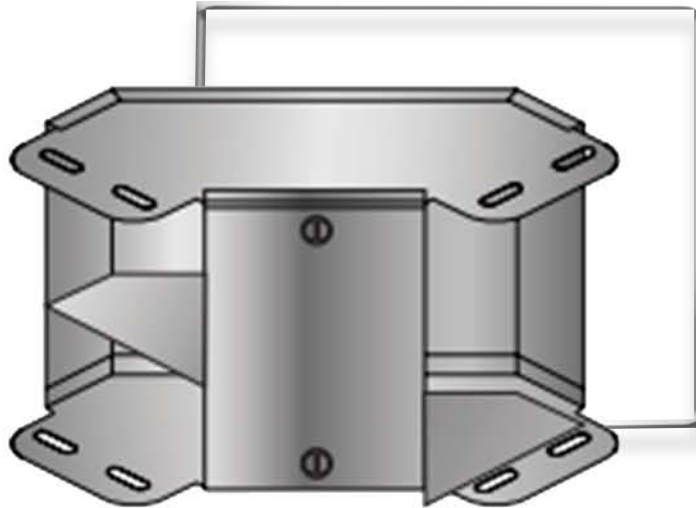

cornered / curved

Bend 90° Inside Lid for Double Compartment

Dimensions	Inch	Item Codes			
		Thickness 1 mm	Thickness 1.2 mm	Thickness 1.5 mm	Thickness 2 mm
50 x 50 mm	(2" x 2")	NHB-90-I2-A	NHB-90-I2-A1	NHB-90-I2-A2	NHB-90-I2-A3
75 x 50 mm	(3" x 2")	NHB-90-I2-B	NHB-90-I2-B1	NHB-90-I2-B2	NHB-90-I2-B3
75 x 75 mm	(3" x 3")	NHB-90-I2-C	NHB-90-I2-C1	NHB-90-I2-C2	NHB-90-I2-C3
100 x 50 mm	(4" x 2")	NHB-90-I2-D	NHB-90-I2-D1	NHB-90-I2-D2	NHB-90-I2-D3
100 x 75 mm	(4" x 3")	NHB-90-I2-E	NHB-90-I2-E1	NHB-90-I2-E2	NHB-90-I2-E3
100 x 100 mm	(4" x 4")	NHB-90-I2-F	NHB-90-I2-F1	NHB-90-I2-F2	NHB-90-I2-F3
150 x 50 mm	(6" x 2")	NHB-90-I2-G	NHB-90-I2-G1	NHB-90-I2-G2	NHB-90-I2-G3
150 x 75 mm	(6" x 3")	NHB-90-I2-H	NHB-90-I2-H1	NHB-90-I2-H2	NHB-90-I2-H3
150 x 100 mm	(6" x 4")	NHB-90-I2-I	NHB-90-I2-I1	NHB-90-I2-I2	NHB-90-I2-I3
150 x 150 mm	(6" x 6")	NHB-90-I2-J	NHB-90-I2-J1	NHB-90-I2-J2	NHB-90-I2-J3
200 x 100 mm	(8" x 4")	NHB-90-I2-K	NHB-90-I2-K1	NHB-90-I2-K2	NHB-90-I2-K3
300 x 100 mm	(12" x 4")	NHB-90-I2-L	NHB-90-I2-L1	NHB-90-I2-L2	NHB-90-I2-L3
450 x 100 mm	(18" x 4")	NHB-90-I2-M	NHB-90-I2-M1	NHB-90-I2-M2	NHB-90-I2-M3
600 x 100 mm	(24" x 4")	NHB-90-I2-N	NHB-90-I2-N1	NHB-90-I2-N2	NHB-90-I2-N3

BEND 90 ° INSIDE LID FOR TRIPLE COMPARTMENT

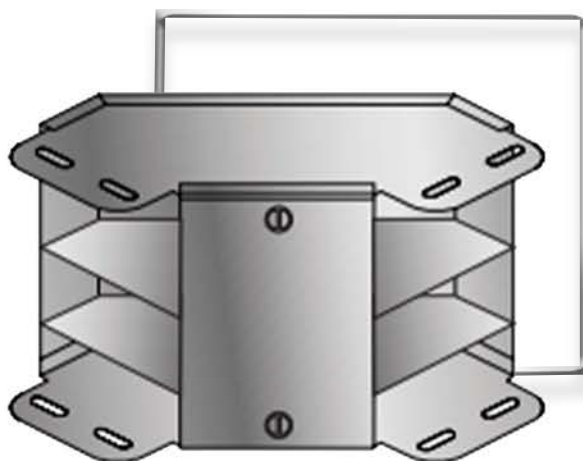

cornered / curved

Bend 90° Inside Lid for Triple Compartment					
Dimensions	Inch	Item Codes			
		Thickness 1 mm	Thickness 1.2 mm	Thickness 1.5 mm	Thickness 2 mm
50 x 50 mm	(2" x 2")	NHB-90-I3-A	NHB-90-I3-A1	NHB-90-I3-A2	NHB-90-I3-A3
75 x 50 mm	(3" x 2")	NHB-90-I3-B	NHB-90-I3-B1	NHB-90-I3-B2	NHB-90-I3-B3
75 x 75 mm	(3" x 3")	NHB-90-I3-C	NHB-90-I3-C1	NHB-90-I3-C2	NHB-90-I3-C3
100 x 50 mm	(4" x 2")	NHB-90-I3-D	NHB-90-I3-D1	NHB-90-I3-D2	NHB-90-I3-D3
100 x 75 mm	(4" x 3")	NHB-90-I3-E	NHB-90-I3-E1	NHB-90-I3-E2	NHB-90-I3-E3
100 x 100 mm	(4" x 4")	NHB-90-I3-F	NHB-90-I3-F1	NHB-90-I3-F2	NHB-90-I3-F3
150 x 50 mm	(6" x 2")	NHB-90-I3-G	NHB-90-I3-G1	NHB-90-I3-G2	NHB-90-I3-G3
150 x 75 mm	(6" x 3")	NHB-90-I3-H	NHB-90-I3-H1	NHB-90-I3-H2	NHB-90-I3-H3
150 x 100 mm	(6" x 4")	NHB-90-I3-I	NHB-90-I3-I1	NHB-90-I3-I2	NHB-90-I3-I3
150 x 150 mm	(6" x 6")	NHB-90-I3-J	NHB-90-I3-J1	NHB-90-I3-J2	NHB-90-I3-J3
200 x 100 mm	(8" x 4")	NHB-90-I3-K	NHB-90-I3-K1	NHB-90-I3-K2	NHB-90-I3-K3
300 x 100 mm	(12" x 4")	NHB-90-I3-L	NHB-90-I3-L1	NHB-90-I3-L2	NHB-90-I3-L3
450 x 100 mm	(18" x 4")	NHB-90-I3-M	NHB-90-I3-M1	NHB-90-I3-M2	NHB-90-I3-M3
600 x 100 mm	(24" x 4")	NHB-90-I3-N	NHB-90-I3-N1	NHB-90-I3-N2	NHB-90-I3-N3

BEND 90 ° OUTSIDE LID FOR SINGLE COMPARTMENT



Type 1: inside

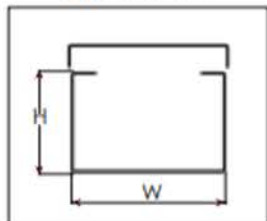

Type 2: outside

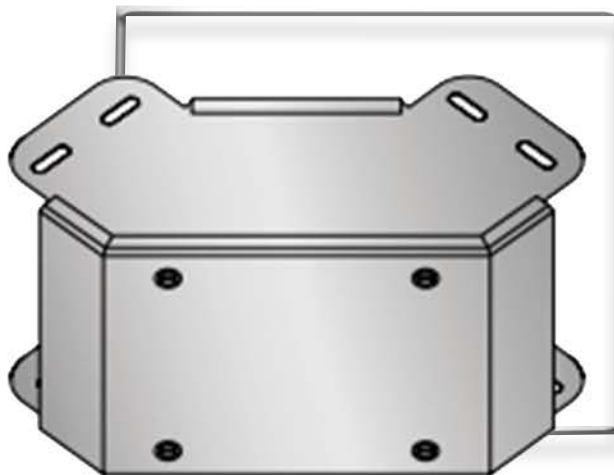
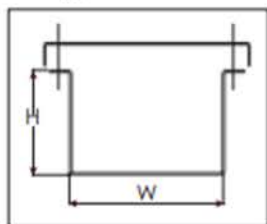

cornered / curved

Bend 90° Outside Lid for Single Compartment

Dimensions	Inch	Item Codes			
		Thickness 1 mm	Thickness 1.2 mm	Thickness 1.5 mm	Thickness 2 mm
50 x 50 mm	(2" x 2")	NHB-90-01-A	NHB-90-01-A1	NHB-90-01-A2	NHB-90-01-A3
75 x 50 mm	(3" x 2")	NHB-90-01-B	NHB-90-01-B1	NHB-90-01-B2	NHB-90-01-B3
75 x 75 mm	(3" x 3")	NHB-90-01-C	NHB-90-01-C1	NHB-90-01-C2	NHB-90-01-C3
100 x 50 mm	(4" x 2")	NHB-90-01-D	NHB-90-01-D1	NHB-90-01-D2	NHB-90-01-D3
100 x 75 mm	(4" x 3")	NHB-90-01-E	NHB-90-01-E1	NHB-90-01-E2	NHB-90-01-E3
100 x 100 mm	(4" x 4")	NHB-90-01-F	NHB-90-01-F1	NHB-90-01-F2	NHB-90-01-F3
150 x 50 mm	(6" x 2")	NHB-90-01-G	NHB-90-01-G1	NHB-90-01-G2	NHB-90-01-G3
150 x 75 mm	(6" x 3")	NHB-90-01-H	NHB-90-01-H1	NHB-90-01-H2	NHB-90-01-H3
150 x 100 mm	(6" x 4")	NHB-90-01-I	NHB-90-01-I1	NHB-90-01-I2	NHB-90-01-I3
150 x 150 mm	(6" x 6")	NHB-90-01-J	NHB-90-01-J1	NHB-90-01-J2	NHB-90-01-J3
200 x 100 mm	(8" x 4")	NHB-90-01-K	NHB-90-01-K1	NHB-90-01-K2	NHB-90-01-K3
300 x 100 mm	(12" x 4")	NHB-90-01-L	NHB-90-01-L1	NHB-90-01-L2	NHB-90-01-L3
450 x 100 mm	(18" x 4")	NHB-90-01-M	NHB-90-01-M1	NHB-90-01-M2	NHB-90-01-M3
600 x 100 mm	(24" x 4")	NHB-90-01-N	NHB-90-01-N1	NHB-90-01-N2	NHB-90-01-N3

BEND 90 ° OUTSIDE LID FOR DOUBLE COMPARTMENT

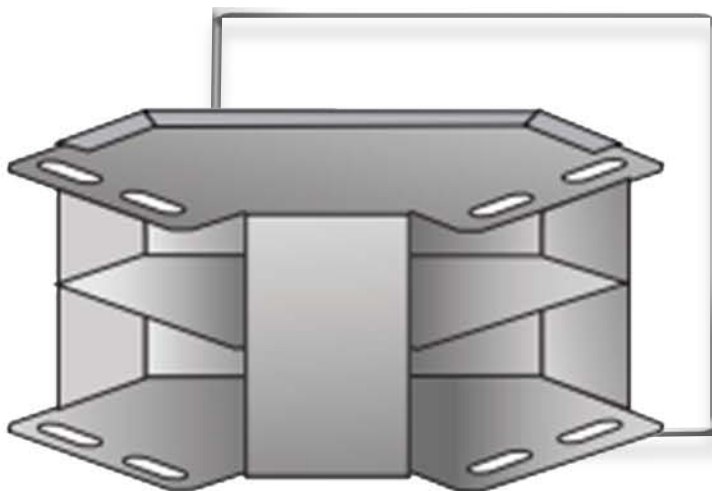

cornered / curved

Bend 90° Outside Lid for Double Compartment

Dimensions	Inch	Item Codes			
		Thickness 1 mm	Thickness 1.2 mm	Thickness 1.5 mm	Thickness 2 mm
50 x 50 mm	(2" x 2")	NHB-90-O2-A	NHB-90-O2-A1	NHB-90-O2-A2	NHB-90-O2-A3
75 x 50 mm	(3" x 2")	NHB-90-O2-B	NHB-90-O2-B1	NHB-90-O2-B2	NHB-90-O2-B3
75 x 75 mm	(3" x 3")	NHB-90-O2-C	NHB-90-O2-C1	NHB-90-O2-C2	NHB-90-O2-C3
100 x 50 mm	(4" x 2")	NHB-90-O2-D	NHB-90-O2-D1	NHB-90-O2-D2	NHB-90-O2-D3
100 x 75 mm	(4" x 3")	NHB-90-O2-E	NHB-90-O2-E1	NHB-90-O2-E2	NHB-90-O2-E3
100 x 100 mm	(4" x 4")	NHB-90-O2-F	NHB-90-O2-F1	NHB-90-O2-F2	NHB-90-O2-F3
150 x 50 mm	(6" x 2")	NHB-90-O2-G	NHB-90-O2-G1	NHB-90-O2-G2	NHB-90-O2-G3
150 x 75 mm	(6" x 3")	NHB-90-O2-H	NHB-90-O2-H1	NHB-90-O2-H2	NHB-90-O2-H3
150 x 100 mm	(6" x 4")	NHB-90-O2-I	NHB-90-O2-I1	NHB-90-O2-I2	NHB-90-O2-I3
150 x 150 mm	(6" x 6")	NHB-90-O2-J	NHB-90-O2-J1	NHB-90-O2-J2	NHB-90-O2-J3
200 x 100 mm	(8" x 4")	NHB-90-O2-K	NHB-90-O2-K1	NHB-90-O2-K2	NHB-90-O2-K3
300 x 100 mm	(12" x 4")	NHB-90-O2-L	NHB-90-O2-L1	NHB-90-O2-L2	NHB-90-O2-L3
450 x 100 mm	(18" x 4")	NHB-90-O2-M	NHB-90-O2-M1	NHB-90-O2-M2	NHB-90-O2-M3
600 x 100 mm	(24" x 4")	NHB-90-O2-N	NHB-90-O2-N1	NHB-90-O2-N2	NHB-90-O2-N3

BEND 90 ° OUTSIDE LID FOR TRIPLE COMPARTMENT

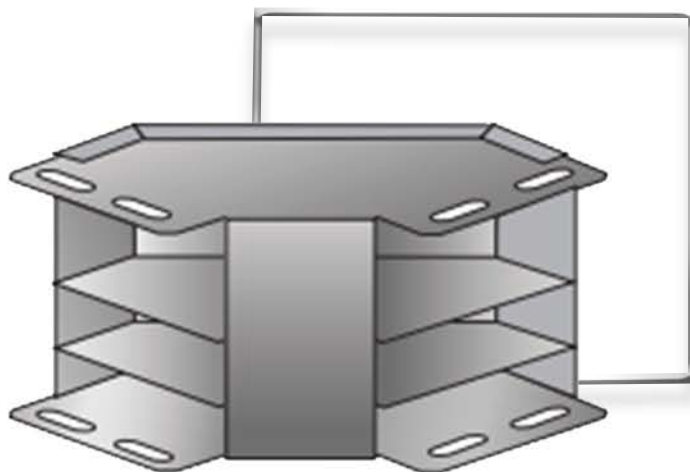

cornered / curved

Bend 90° Outside Lid for Triple Compartment

Dimensions	Inch	Item Codes			
		Thickness 1 mm	Thickness 1.2 mm	Thickness 1.5 mm	Thickness 2 mm
50 x 50 mm	(2" x 2")	NHB-90-03-A	NHB-90-03-A1	NHB-90-03-A2	NHB-90-03-A3
75 x 50 mm	(3" x 2")	NHB-90-03-B	NHB-90-03-B1	NHB-90-03-B2	NHB-90-03-B3
75 x 75 mm	(3" x 3")	NHB-90-03-C	NHB-90-03-C1	NHB-90-03-C2	NHB-90-03-C3
100 x 50 mm	(4" x 2")	NHB-90-03-D	NHB-90-03-D1	NHB-90-03-D2	NHB-90-03-D3
100 x 75 mm	(4" x 3")	NHB-90-03-E	NHB-90-03-E1	NHB-90-03-E2	NHB-90-03-E3
100 x 100 mm	(4" x 4")	NHB-90-03-F	NHB-90-03-F1	NHB-90-03-F2	NHB-90-03-F3
150 x 50 mm	(6" x 2")	NHB-90-03-G	NHB-90-03-G1	NHB-90-03-G2	NHB-90-03-G3
150 x 75 mm	(6" x 3")	NHB-90-03-H	NHB-90-03-H1	NHB-90-03-H2	NHB-90-03-H3
150 x 100 mm	(6" x 4")	NHB-90-03-I	NHB-90-03-I1	NHB-90-03-I2	NHB-90-03-I3
150 x 150 mm	(6" x 6")	NHB-90-03-J	NHB-90-03-J1	NHB-90-03-J2	NHB-90-03-J3
200 x 100 mm	(8" x 4")	NHB-90-03-K	NHB-90-03-K1	NHB-90-03-K2	NHB-90-03-K3
300 x 100 mm	(12" x 4")	NHB-90-03-L	NHB-90-03-L1	NHB-90-03-L2	NHB-90-03-L3
450 x 100 mm	(18" x 4")	NHB-90-03-M	NHB-90-03-M1	NHB-90-03-M2	NHB-90-03-M3
600 x 100 mm	(24" x 4")	NHB-90-03-N	NHB-90-03-N1	NHB-90-03-N2	NHB-90-03-N3

90° HORIZONTAL OFFSET

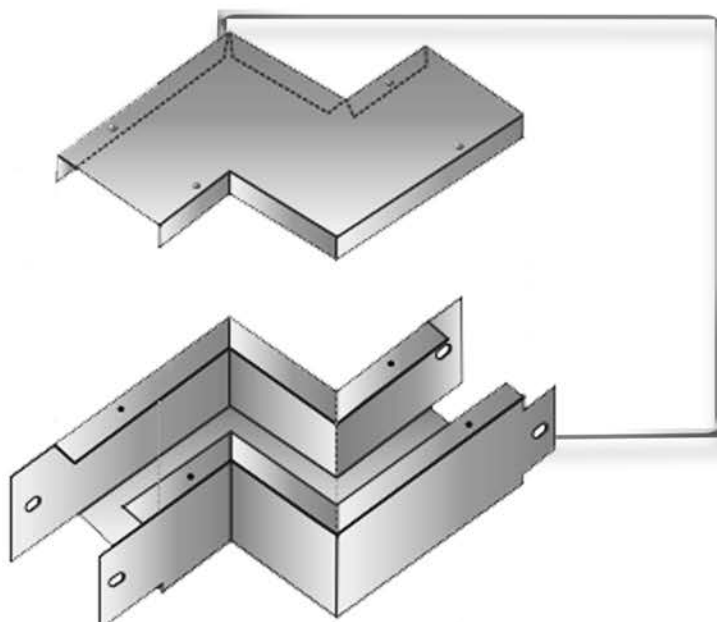

cornered / curved

90° Horizontal Offset					
Dimensions	Inch	Item Codes			
		Thickness 1 mm	Thickness 1.2 mm	Thickness 1.5 mm	Thickness 2 mm
50 x 50 mm	(2" x 2")	NHO-90-A	NHO-90-A1	NHO-90-A2	NHO-90-A3
75 x 50 mm	(3" x 2")	NHO-90-B	NHO-90-B1	NHO-90-B2	NHO-90-B3
75 x 75 mm	(3" x 3")	NHO-90-C	NHO-90-C1	NHO-90-C2	NHO-90-C3
100 x 50 mm	(4" x 2")	NHO-90-D	NHO-90-D1	NHO-90-D2	NHO-90-D3
100 x 75 mm	(4" x 3")	NHO-90-E	NHO-90-E1	NHO-90-E2	NHO-90-E3
100 x 100 mm	(4" x 4")	NHO-90-F	NHO-90-F1	NHO-90-F2	NHO-90-F3
150 x 50 mm	(6" x 2")	NHO-90-G	NHO-90-G1	NHO-90-G2	NHO-90-G3
150 x 75 mm	(6" x 3")	NHO-90-H	NHO-90-H1	NHO-90-H2	NHO-90-H3
150 x 100 mm	(6" x 4")	NHO-90-I	NHO-90-I1	NHO-90-I2	NHO-90-I3
150 x 150 mm	(6" x 6")	NHO-90-J	NHO-90-J1	NHO-90-J2	NHO-90-J3
200 x 100 mm	(8" x 4")	NHO-90-K	NHO-90-K1	NHO-90-K2	NHO-90-K3
300 x 100 mm	(12" x 4")	NHO-90-L	NHO-90-L1	NHO-90-L2	NHO-90-L3
450 x 100 mm	(18" x 4")	NHO-90-M	NHO-90-M1	NHO-90-M2	NHO-90-M3
600 x 100 mm	(24" x 4")	NHO-90-N	NHO-90-N1	NHO-90-N2	NHO-90-N3

90° INTERNAL RISER

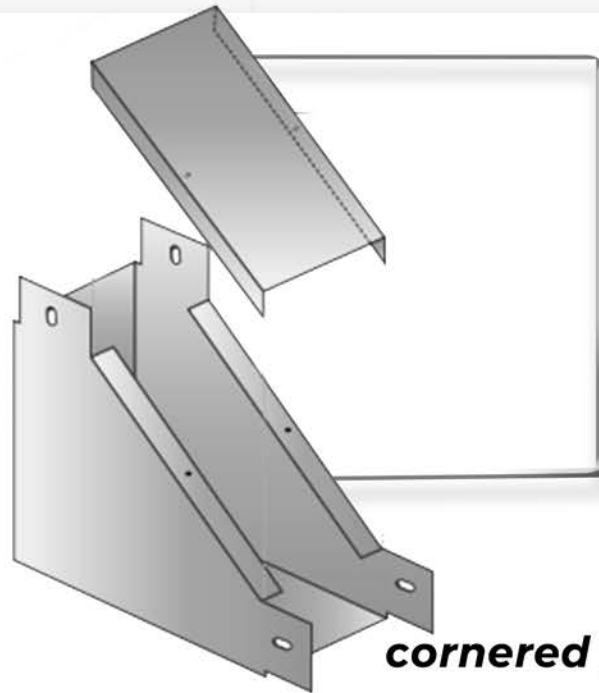

cornered / curved

90° Internal Riser					
Dimensions	Inch	Item Codes			
		Thickness 1 mm	Thickness 1.2 mm	Thickness 1.5 mm	Thickness 2 mm
50 x 50 mm	(2" x 2")	NIR-90-A	NIR-90-A1	NIR-90-A2	NIR-90-A3
75 x 50 mm	(3" x 2")	NIR-90-B	NIR-90-B1	NIR-90-B2	NIR-90-B3
75 x 75 mm	(3" x 3")	NIR-90-C	NIR-90-C1	NIR-90-C2	NIR-90-C3
100 x 50 mm	(4" x 2")	NIR-90-D	NIR-90-D1	NIR-90-D2	NIR-90-D3
100 x 75 mm	(4" x 3")	NIR-90-E	NIR-90-E1	NIR-90-E2	NIR-90-E3
100 x 100 mm	(4" x 4")	NIR-90-F	NIR-90-F1	NIR-90-F2	NIR-90-F3
150 x 50 mm	(6" x 2")	NIR-90-G	NIR-90-G1	NIR-90-G2	NIR-90-G3
150 x 75 mm	(6" x 3")	NIR-90-H	NIR-90-H1	NIR-90-H2	NIR-90-H3
150 x 100 mm	(6" x 4")	NIR-90-I	NIR-90-I1	NIR-90-I2	NIR-90-I3
150 x 150 mm	(6" x 6")	NIR-90-J	NIR-90-J1	NIR-90-J2	NIR-90-J3
200 x 100 mm	(8" x 4")	NIR-90-K	NIR-90-K1	NIR-90-K2	NIR-90-K3
300 x 100 mm	(12" x 4")	NIR-90-L	NIR-90-L1	NIR-90-L2	NIR-90-L3
450 x 100 mm	(18" x 4")	NIR-90-M	NIR-90-M1	NIR-90-M2	NIR-90-M3
600 x 100 mm	(24" x 4")	NIR-90-N	NIR-90-N1	NIR-90-N2	NIR-90-N3

90° EXTERNAL RISER

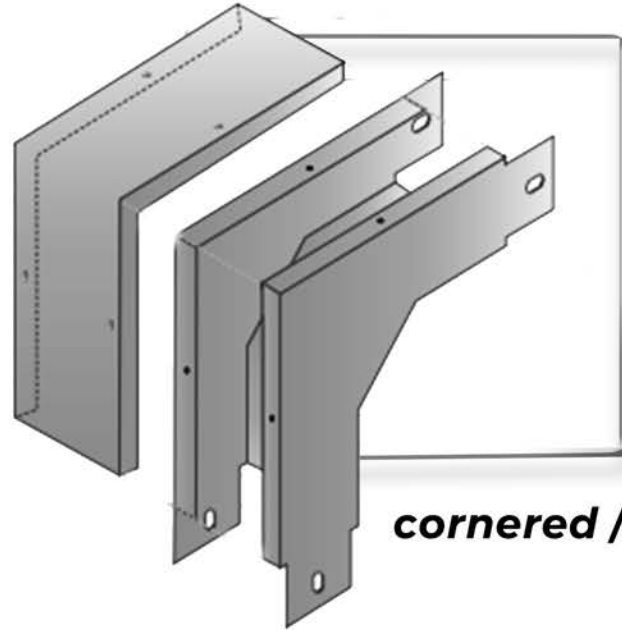

cornered / curved

90° External Riser

Dimensions	Inch	Item Codes			
		Thickness 1 mm	Thickness 1.2 mm	Thickness 1.5 mm	Thickness 2 mm
50 x 50 mm	(2" x 2")	NER-90-A	NER-90-A1	NER-90-A2	NER-90-A3
75 x 50 mm	(3" x 2")	NER-90-B	NER-90-B1	NER-90-B2	NER-90-B3
75 x 75 mm	(3" x 3")	NER-90-C	NER-90-C1	NER-90-C2	NER-90-C3
100 x 50 mm	(4" x 2")	NER-90-D	NER-90-D1	NER-90-D2	NER-90-D3
100 x 75 mm	(4" x 3")	NER-90-E	NER-90-E1	NER-90-E2	NER-90-E3
100 x 100 mm	(4" x 4")	NER-90-F	NER-90-F1	NER-90-F2	NER-90-F3
150 x 50 mm	(6" x 2")	NER-90-G	NER-90-G1	NER-90-G2	NER-90-G3
150 x 75 mm	(6" x 3")	NER-90-H	NER-90-H1	NER-90-H2	NER-90-H3
150 x 100 mm	(6" x 4")	NER-90-I	NER-90-I1	NER-90-I2	NER-90-I3
150 x 150 mm	(6" x 6")	NER-90-J	NER-90-J1	NER-90-J2	NER-90-J3
200 x 100 mm	(8" x 4")	NER-90-K	NER-90-K1	NER-90-K2	NER-90-K3
300 x 100 mm	(12" x 4")	NER-90-L	NER-90-L1	NER-90-L2	NER-90-L3
450 x 100 mm	(18" x 4")	NER-90-M	NER-90-M1	NER-90-M2	NER-90-M3
600 x 100 mm	(24" x 4")	NER-90-N	NER-90-N1	NER-90-N2	NER-90-N3

TEE BEND TOP LID FOR SINGLE COMPARTMENT

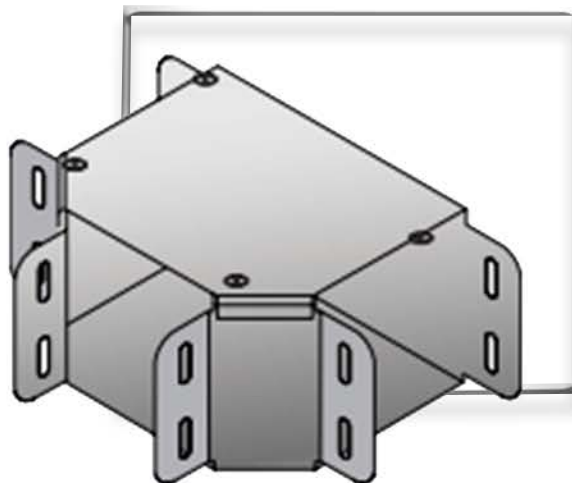
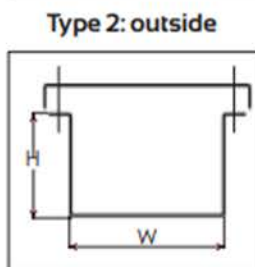
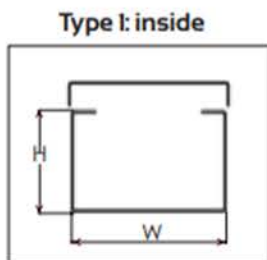

cornered / curved

Tee Bend Top Lid For Single Compartment

Dimensions	Inch	Item Codes			
		Thickness 1 mm	Thickness 1.2 mm	Thickness 1.5 mm	Thickness 2 mm
50 x 50 mm	(2" x 2")	NTB-T1-A	NTB-T1-A1	NTB-T1-A2	NTB-T1-A3
75 x 50 mm	(3" x 2")	NTB-T1-B	NTB-T1-B1	NTB-T1-B2	NTB-T1-B3
75 x 75 mm	(3" x 3")	NTB-T1-C	NTB-T1-C1	NTB-T1-C2	NTB-T1-C3
100 x 50 mm	(4" x 2")	NTB-T1-D	NTB-T1-D1	NTB-T1-D2	NTB-T1-D3
100 x 75 mm	(4" x 3")	NTB-T1-E	NTB-T1-E1	NTB-T1-E2	NTB-T1-E3
100 x 100 mm	(4" x 4")	NTB-T1-F	NTB-T1-F1	NTB-T1-F2	NTB-T1-F3
150 x 50 mm	(6" x 2")	NTB-T1-G	NTB-T1-G1	NTB-T1-G2	NTB-T1-G3
150 x 75 mm	(6" x 3")	NTB-T1-H	NTB-T1-H1	NTB-T1-H2	NTB-T1-H3
150 x 100 mm	(6" x 4")	NTB-T1-I	NTB-T1-I1	NTB-T1-I2	NTB-T1-I3
150 x 150 mm	(6" x 6")	NTB-T1-J	NTB-T1-J1	NTB-T1-J2	NTB-T1-J3
200 x 100 mm	(8" x 4")	NTB-T1-K	NTB-T1-K1	NTB-T1-K2	NTB-T1-K3
300 x 100 mm	(12" x 4")	NTB-T1-L	NTB-T1-L1	NTB-T1-L2	NTB-T1-L3
450 x 100 mm	(18" x 4")	NTB-T1-M	NTB-T1-M1	NTB-T1-M2	NTB-T1-M3
600 x 100 mm	(24" x 4")	NTB-T1-N	NTB-T1-N1	NTB-T1-N2	NTB-T1-N3

TEE BEND TOP LID FOR DOUBLE COMPARTMENT

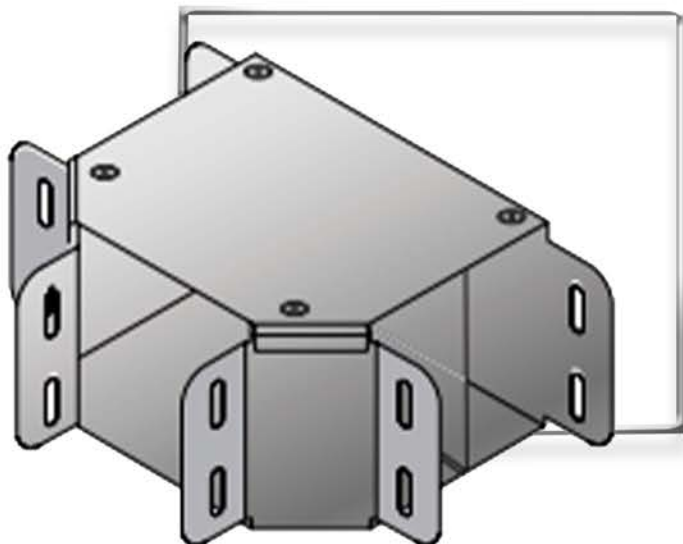

cornered / curved

Tee Bend Top Lid For Double Compartment					
Dimensions	Inch	Item Codes			
		Thickness 1 mm	Thickness 1.2 mm	Thickness 1.5 mm	Thickness 2 mm
50 x 50 mm	(2" x 2")	NTB-T2-A	NTB-T2-A1	NTB-T2-A2	NTB-T2-A3
75 x 50 mm	(3" x 2")	NTB-T2-B	NTB-T2-B1	NTB-T2-B2	NTB-T2-B3
75 x 75 mm	(3" x 3")	NTB-T2-C	NTB-T2-C1	NTB-T2-C2	NTB-T2-C3
100 x 50 mm	(4" x 2")	NTB-T2-D	NTB-T2-D1	NTB-T2-D2	NTB-T2-D3
100 x 75 mm	(4" x 3")	NTB-T2-E	NTB-T2-E1	NTB-T2-E2	NTB-T2-E3
100 x 100 mm	(4" x 4")	NTB-T2-F	NTB-T2-F1	NTB-T2-F2	NTB-T2-F3
150 x 50 mm	(6" x 2")	NTB-T2-G	NTB-T2-G1	NTB-T2-G2	NTB-T2-G3
150 x 75 mm	(6" x 3")	NTB-T2-H	NTB-T2-H1	NTB-T2-H2	NTB-T2-H3
150 x 100 mm	(6" x 4")	NTB-T2-I	NTB-T2-I1	NTB-T2-I2	NTB-T2-I3
150 x 150 mm	(6" x 6")	NTB-T2-J	NTB-T2-J1	NTB-T2-J2	NTB-T2-J3
200 x 100 mm	(8" x 4")	NTB-T2-K	NTB-T2-K1	NTB-T2-K2	NTB-T2-K3
300 x 100 mm	(12" x 4")	NTB-T2-L	NTB-T2-L1	NTB-T2-L2	NTB-T2-L3
450 x 100 mm	(18" x 4")	NTB-T2-M	NTB-T2-M1	NTB-T2-M2	NTB-T2-M3
600 x 100 mm	(24" x 4")	NTB-T2-N	NTB-T2-N1	NTB-T2-N2	NTB-T2-N3

TEE BEND TOP LID FOR TRIPLE COMPARTMENT

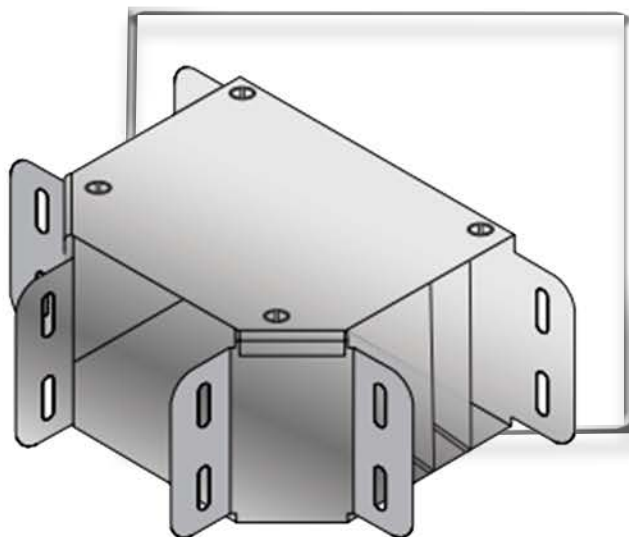

cornered / curved

Tee Bend Top Lid For Triple Compartment

Dimensions	Inch	Item Codes			
		Thickness 1 mm	Thickness 1.2 mm	Thickness 1.5 mm	Thickness 2 mm
50 x 50 mm	(2" x 2")	NTB-T3-A	NTB-T3-A1	NTB-T3-A2	NTB-T3-A3
75 x 50 mm	(3" x 2")	NTB-T3-B	NTB-T3-B1	NTB-T3-B2	NTB-T3-B3
75 x 75 mm	(3" x 3")	NTB-T3-C	NTB-T3-C1	NTB-T3-C2	NTB-T3-C3
100 x 50 mm	(4" x 2")	NTB-T3-D	NTB-T3-D1	NTB-T3-D2	NTB-T3-D3
100 x 75 mm	(4" x 3")	NTB-T3-E	NTB-T3-E1	NTB-T3-E2	NTB-T3-E3
100 x 100 mm	(4" x 4")	NTB-T3-F	NTB-T3-F1	NTB-T3-F2	NTB-T3-F3
150 x 50 mm	(6" x 2")	NTB-T3-G	NTB-T3-G1	NTB-T3-G2	NTB-T3-G3
150 x 75 mm	(6" x 3")	NTB-T3-H	NTB-T3-H1	NTB-T3-H2	NTB-T3-H3
150 x 100 mm	(6" x 4")	NTB-T3-I	NTB-T3-I1	NTB-T3-I2	NTB-T3-I3
150 x 150 mm	(6" x 6")	NTB-T3-J	NTB-T3-J1	NTB-T3-J2	NTB-T3-J3
200 x 100 mm	(8" x 4")	NTB-T3-K	NTB-T3-K1	NTB-T3-K2	NTB-T3-K3
300 x 100 mm	(12" x 4")	NTB-T3-L	NTB-T3-L1	NTB-T3-L2	NTB-T3-L3
450 x 100 mm	(18" x 4")	NTB-T3-M	NTB-T3-M1	NTB-T3-M2	NTB-T3-M3
600 x 100 mm	(24" x 4")	NTB-T3-N	NTB-T3-N1	NTB-T3-N2	NTB-T3-N3

TEE BEND INSIDE LID FOR SINGLE COMPARTMENT

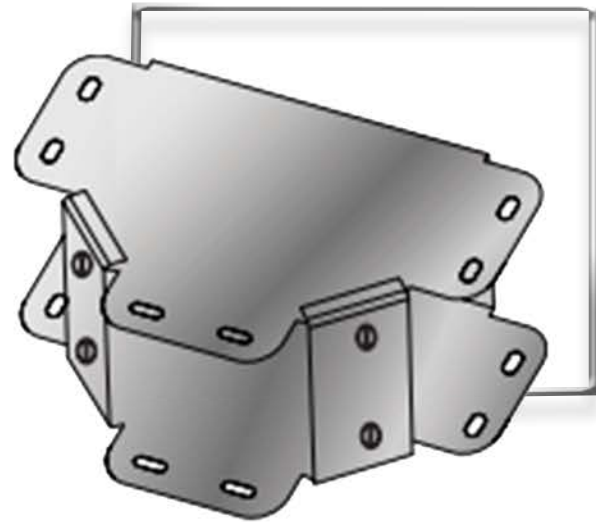
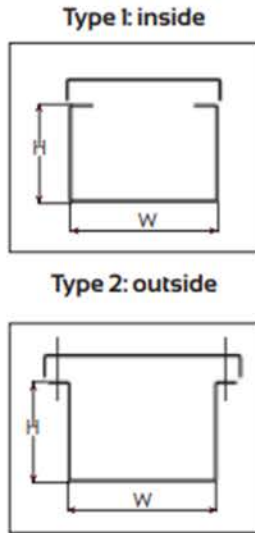

cornered / curved

Tee Bend Inside Lid For Single Compartment

Dimensions	Inch	Item Codes			
		Thickness 1 mm	Thickness 1.2 mm	Thickness 1.5 mm	Thickness 2 mm
50 x 50 mm	(2" x 2")	NTBI-T1-A	NTBI-T1-A1	NTBI-T1-A2	NTBI-T1-A3
75 x 50 mm	(3" x 2")	NTBI-T1-B	NTBI-T1-B1	NTBI-T1-B2	NTBI-T1-B3
75 x 75 mm	(3" x 3")	NTBI-T1-C	NTBI-T1-C1	NTBI-T1-C2	NTBI-T1-C3
100 x 50 mm	(4" x 2")	NTBI-T1-D	NTBI-T1-D1	NTBI-T1-D2	NTBI-T1-D3
100 x 75 mm	(4" x 3")	NTBI-T1-E	NTBI-T1-E1	NTBI-T1-E2	NTBI-T1-E3
100 x 100 mm	(4" x 4")	NTBI-T1-F	NTBI-T1-F1	NTBI-T1-F2	NTBI-T1-F3
150 x 50 mm	(6" x 2")	NTBI-T1-G	NTBI-T1-G1	NTBI-T1-G2	NTBI-T1-G3
150 x 75 mm	(6" x 3")	NTBI-T1-H	NTBI-T1-H1	NTBI-T1-H2	NTBI-T1-H3
150 x 100 mm	(6" x 4")	NTBI-T1-I	NTBI-T1-I1	NTBI-T1-I2	NTBI-T1-I3
150 x 150 mm	(6" x 6")	NTBI-T1-J	NTBI-T1-J1	NTBI-T1-J2	NTBI-T1-J3
200 x 100 mm	(8" x 4")	NTBI-T1-K	NTBI-T1-K1	NTBI-T1-K2	NTBI-T1-K3
300 x 100 mm	(12" x 4")	NTBI-T1-L	NTBI-T1-L1	NTBI-T1-L2	NTBI-T1-L3
450 x 100 mm	(18" x 4")	NTBI-T1-M	NTBI-T1-M1	NTBI-T1-M2	NTBI-T1-M3
600 x 100 mm	(24" x 4")	NTBI-T1-N	NTBI-T1-N1	NTBI-T1-N2	NTBI-T1-N3

TEE BEND INSIDE LID FOR DOUBLE COMPARTMENT

Type 1: inside

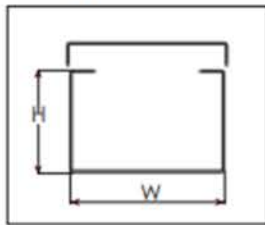

Type 2: outside

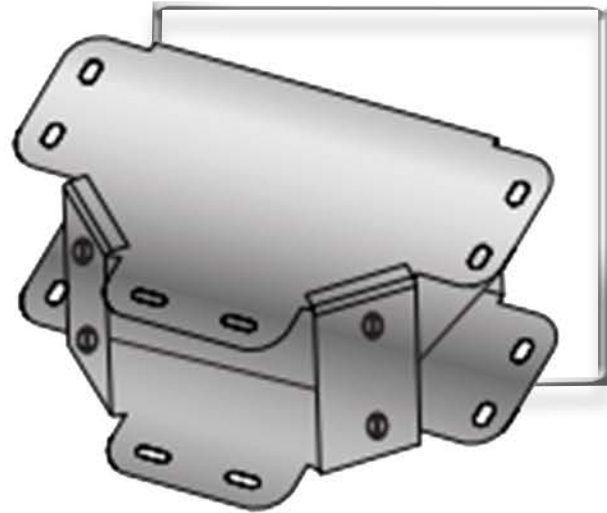
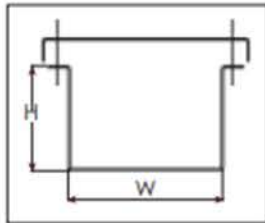

cornered / curved

Tee Bend Inside Lid For Double Compartment

Dimensions	Inch	Item Codes			
		Thickness 1 mm	Thickness 1.2 mm	Thickness 1.5 mm	Thickness 2 mm
50 x 50 mm	(2" x 2")	NTBI-T2-A	NTBI-T2-A1	NTBI-T2-A2	NTBI-T2-A3
75 x 50 mm	(3" x 2")	NTBI-T2-B	NTBI-T2-B1	NTBI-T2-B2	NTBI-T2-B3
75 x 75 mm	(3" x 3")	NTBI-T2-C	NTBI-T2-C1	NTBI-T2-C2	NTBI-T2-C3
100 x 50 mm	(4" x 2")	NTBI-T2-D	NTBI-T2-D1	NTBI-T2-D2	NTBI-T2-D3
100 x 75 mm	(4" x 3")	NTBI-T2-E	NTBI-T2-E1	NTBI-T2-E2	NTBI-T2-E3
100 x 100 mm	(4" x 4")	NTBI-T2-F	NTBI-T2-F1	NTBI-T2-F2	NTBI-T2-F3
150 x 50 mm	(6" x 2")	NTBI-T2-G	NTBI-T2-G1	NTBI-T2-G2	NTBI-T2-G3
150 x 75 mm	(6" x 3")	NTBI-T2-H	NTBI-T2-H1	NTBI-T2-H2	NTBI-T2-H3
150 x 100 mm	(6" x 4")	NTBI-T2-I	NTBI-T2-I1	NTBI-T2-I2	NTBI-T2-I3
150 x 150 mm	(6" x 6")	NTBI-T2-J	NTBI-T2-J1	NTBI-T2-J2	NTBI-T2-J3
200 x 100 mm	(8" x 4")	NTBI-T2-K	NTBI-T2-K1	NTBI-T2-K2	NTBI-T2-K3
300 x 100 mm	(12" x 4")	NTBI-T2-L	NTBI-T2-L1	NTBI-T2-L2	NTBI-T2-L3
450 x 100 mm	(18" x 4")	NTBI-T2-M	NTBI-T2-M1	NTBI-T2-M2	NTBI-T2-M3
600 x 100 mm	(24" x 4")	NTBI-T2-N	NTBI-T2-N1	NTBI-T2-N2	NTBI-T2-N3

TEE BEND INSIDE LID FOR TRIPLE COMPARTMENT



Type 1: inside

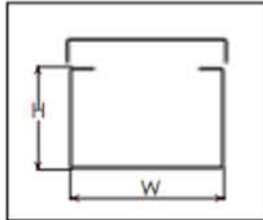

Type 2: outside

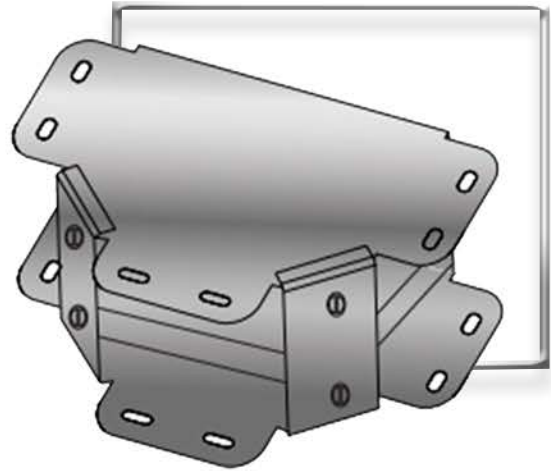
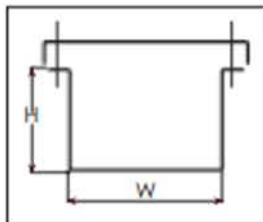

cornered / curved

Tee Bend Inside Lid For Triple Compartment

Dimensions	Inch	Item Codes			
		Thickness 1 mm	Thickness 1.2 mm	Thickness 1.5 mm	Thickness 2 mm
50 x 50 mm	(2" x 2")	NTBI-T3-A	NTBI-T3-A1	NTBI-T3-A2	NTBI-T3-A3
75 x 50 mm	(3" x 2")	NTBI-T3-B	NTBI-T3-B1	NTBI-T3-B2	NTBI-T3-B3
75 x 75 mm	(3" x 3")	NTBI-T3-C	NTBI-T3-C1	NTBI-T3-C2	NTBI-T3-C3
100 x 50 mm	(4" x 2")	NTBI-T3-D	NTBI-T3-D1	NTBI-T3-D2	NTBI-T3-D3
100 x 75 mm	(4" x 3")	NTBI-T3-E	NTBI-T3-E1	NTBI-T3-E2	NTBI-T3-E3
100 x 100 mm	(4" x 4")	NTBI-T3-F	NTBI-T3-F1	NTBI-T3-F2	NTBI-T3-F3
150 x 50 mm	(6" x 2")	NTBI-T3-G	NTBI-T3-G1	NTBI-T3-G2	NTBI-T3-G3
150 x 75 mm	(6" x 3")	NTBI-T3-H	NTBI-T3-H1	NTBI-T3-H2	NTBI-T3-H3
150 x 100 mm	(6" x 4")	NTBI-T3-I	NTBI-T3-I1	NTBI-T3-I2	NTBI-T3-I3
150 x 150 mm	(6" x 6")	NTBI-T3-J	NTBI-T3-J1	NTBI-T3-J2	NTBI-T3-J3
200 x 100 mm	(8" x 4")	NTBI-T3-K	NTBI-T3-K1	NTBI-T3-K2	NTBI-T3-K3
300 x 100 mm	(12" x 4")	NTBI-T3-L	NTBI-T3-L1	NTBI-T3-L2	NTBI-T3-L3
450 x 100 mm	(18" x 4")	NTBI-T3-M	NTBI-T3-M1	NTBI-T3-M2	NTBI-T3-M3
600 x 100 mm	(24" x 4")	NTBI-T3-N	NTBI-T3-N1	NTBI-T3-N2	NTBI-T3-N3

TEE BEND OUTSIDE LID FOR SINGLE COMPARTMENT

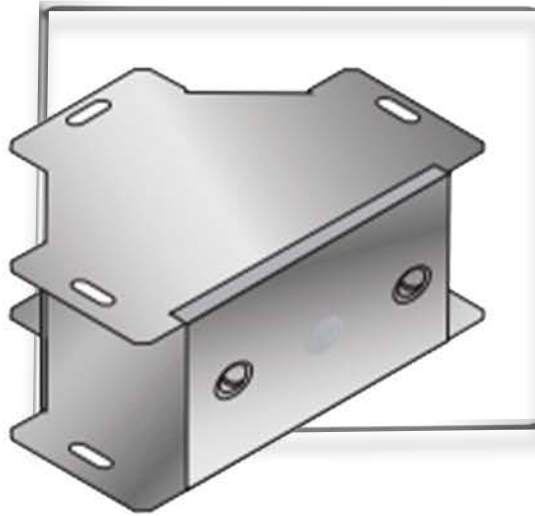

cornered / curved

Tee Bend Outside Lid For Single Compartment

Dimensions	Inch	Item Codes			
		Thickness 1 mm	Thickness 1.2 mm	Thickness 1.5 mm	Thickness 2 mm
50 x 50 mm	(2" x 2")	NTBO-T1-A	NTBO-T1-A1	NTBO-T1-A2	NTBO-T1-A3
75 x 50 mm	(3" x 2")	NTBO-T1-B	NTBO-T1-B1	NTBO-T1-B2	NTBO-T1-B3
75 x 75 mm	(3" x 3")	NTBO-T1-C	NTBO-T1-C1	NTBO-T1-C2	NTBO-T1-C3
100 x 50 mm	(4" x 2")	NTBO-T1-D	NTBO-T1-D1	NTBO-T1-D2	NTBO-T1-D3
100 x 75 mm	(4" x 3")	NTBO-T1-E	NTBO-T1-E1	NTBO-T1-E2	NTBO-T1-E3
100 x 100 mm	(4" x 4")	NTBO-T1-F	NTBO-T1-F1	NTBO-T1-F2	NTBO-T1-F3
150 x 50 mm	(6" x 2")	NTBO-T1-G	NTBO-T1-G1	NTBO-T1-G2	NTBO-T1-G3
150 x 75 mm	(6" x 3")	NTBO-T1-H	NTBO-T1-H1	NTBO-T1-H2	NTBO-T1-H3
150 x 100 mm	(6" x 4")	NTBO-T1-I	NTBO-T1-I1	NTBO-T1-I2	NTBO-T1-I3
150 x 150 mm	(6" x 6")	NTBO-T1-J	NTBO-T1-J1	NTBO-T1-J2	NTBO-T1-J3
200 x 100 mm	(8" x 4")	NTBO-T1-K	NTBO-T1-K1	NTBO-T1-K2	NTBO-T1-K3
300 x 100 mm	(12" x 4")	NTBO-T1-L	NTBO-T1-L1	NTBO-T1-L2	NTBO-T1-L3
450 x 100 mm	(18" x 4")	NTBO-T1-M	NTBO-T1-M1	NTBO-T1-M2	NTBO-T1-M3
600 x 100 mm	(24" x 4")	NTBO-T1-N	NTBO-T1-N1	NTBO-T1-N2	NTBO-T1-N3

TEE BEND OUTSIDE LID FOR DOUBLE COMPARTMENT

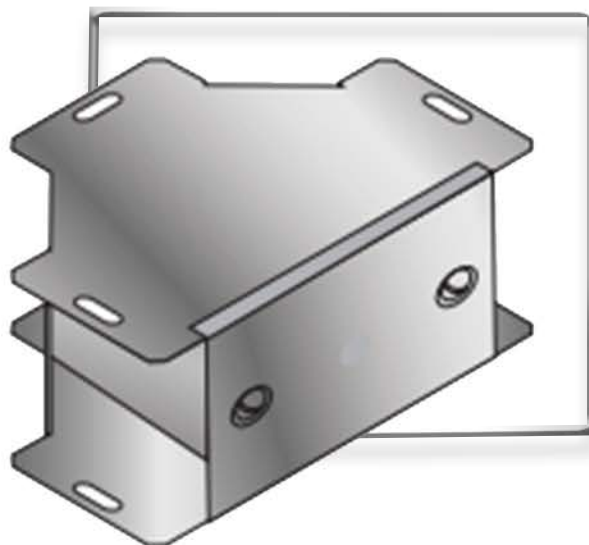

cornered / curved

Tee Bend Outside Lid For Double Compartment					
Dimensions	Inch	Item Codes			
		Thickness 1 mm	Thickness 1.2 mm	Thickness 1.5 mm	Thickness 2 mm
50 x 50 mm	(2" x 2")	NTBO-T2-A	NTBO-T2-A1	NTBO-T2-A2	NTBO-T2-A3
75 x 50 mm	(3" x 2")	NTBO-T2-B	NTBO-T2-B1	NTBO-T2-B2	NTBO-T2-B3
75 x 75 mm	(3" x 3")	NTBO-T2-C	NTBO-T2-C1	NTBO-T2-C2	NTBO-T2-C3
100 x 50 mm	(4" x 2")	NTBO-T2-D	NTBO-T2-D1	NTBO-T2-D2	NTBO-T2-D3
100 x 75 mm	(4" x 3")	NTBO-T2-E	NTBO-T2-E1	NTBO-T2-E2	NTBO-T2-E3
100 x 100 mm	(4" x 4")	NTBO-T2-F	NTBO-T2-F1	NTBO-T2-F2	NTBO-T2-F3
150 x 50 mm	(6" x 2")	NTBO-T2-G	NTBO-T2-G1	NTBO-T2-G2	NTBO-T2-G3
150 x 75 mm	(6" x 3")	NTBO-T2-H	NTBO-T2-H1	NTBO-T2-H2	NTBO-T2-H3
150 x 100 mm	(6" x 4")	NTBO-T2-I	NTBO-T2-I1	NTBO-T2-I2	NTBO-T2-I3
150 x 150 mm	(6" x 6")	NTBO-T2-J	NTBO-T2-J1	NTBO-T2-J2	NTBO-T2-J3
200 x 100 mm	(8" x 4")	NTBO-T2-K	NTBO-T2-K1	NTBO-T2-K2	NTBO-T2-K3
300 x 100 mm	(12" x 4")	NTBO-T2-L	NTBO-T2-L1	NTBO-T2-L2	NTBO-T2-L3
450 x 100 mm	(18" x 4")	NTBO-T2-M	NTBO-T2-M1	NTBO-T2-M2	NTBO-T2-M3
600 x 100 mm	(24" x 4")	NTBO-T2-N	NTBO-T2-N1	NTBO-T2-N2	NTBO-T2-N3

TEE BEND OUTSIDE LID FOR TRIPLE COMPARTMENT

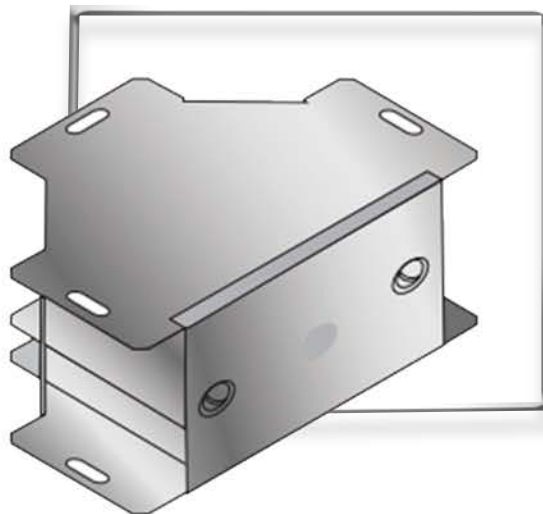

cornered / curved

Tee Bend Outside Lid For Triple Compartment

Dimensions	Inch	Item Codes			
		Thickness 1 mm	Thickness 1.2 mm	Thickness 1.5 mm	Thickness 2 mm
50 x 50 mm	(2" x 2")	NTBO-T3-A	NTBO-T3-A1	NTBO-T3-A2	NTBO-T3-A3
75 x 50 mm	(3" x 2")	NTBO-T3-B	NTBO-T3-B1	NTBO-T3-B2	NTBO-T3-B3
75 x 75 mm	(3" x 3")	NTBO-T3-C	NTBO-T3-C1	NTBO-T3-C2	NTBO-T3-C3
100 x 50 mm	(4" x 2")	NTBO-T3-D	NTBO-T3-D1	NTBO-T3-D2	NTBO-T3-D3
100 x 75 mm	(4" x 3")	NTBO-T3-E	NTBO-T3-E1	NTBO-T3-E2	NTBO-T3-E3
100 x 100 mm	(4" x 4")	NTBO-T3-F	NTBO-T3-F1	NTBO-T3-F2	NTBO-T3-F3
150 x 50 mm	(6" x 2")	NTBO-T3-G	NTBO-T3-G1	NTBO-T3-G2	NTBO-T3-G3
150 x 75 mm	(6" x 3")	NTBO-T3-H	NTBO-T3-H1	NTBO-T3-H2	NTBO-T3-H3
150 x 100 mm	(6" x 4")	NTBO-T3-I	NTBO-T3-I1	NTBO-T3-I2	NTBO-T3-I3
150 x 150 mm	(6" x 6")	NTBO-T3-J	NTBO-T3-J1	NTBO-T3-J2	NTBO-T3-J3
200 x 100 mm	(8" x 4")	NTBO-T3-K	NTBO-T3-K1	NTBO-T3-K2	NTBO-T3-K3
300 x 100 mm	(12" x 4")	NTBO-T3-L	NTBO-T3-L1	NTBO-T3-L2	NTBO-T3-L3
450 x 100 mm	(18" x 4")	NTBO-T3-M	NTBO-T3-M1	NTBO-T3-M2	NTBO-T3-M3
600 x 100 mm	(24" x 4")	NTBO-T3-N	NTBO-T3-N1	NTBO-T3-N2	NTBO-T3-N3

INTERSECTION FOR SINGLE COMPARTMENT

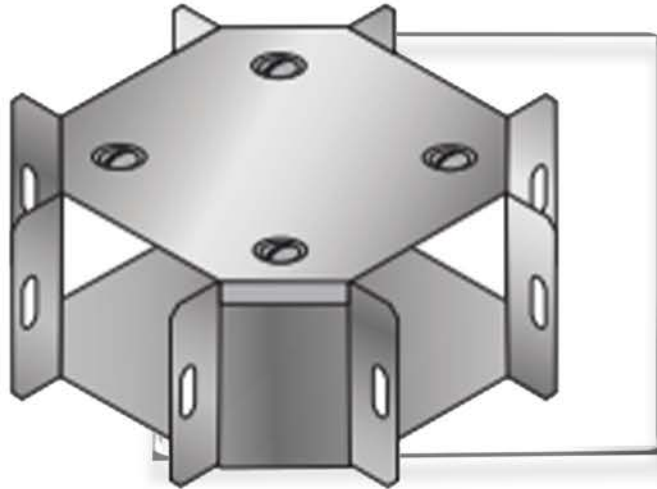

cornered / curved

Intersection For Single Compartment

Dimensions	Inch	Item Codes			
		Thickness 1 mm	Thickness 1.2 mm	Thickness 1.5 mm	Thickness 2 mm
50 x 50 mm	(2" x 2")	NI-T1-A	NI-T1-A1	NI-T1-A2	NI-T1-A3
75 x 50 mm	(3" x 2")	NI-T1-B	NI-T1-B1	NI-T1-B2	NI-T1-B3
75 x 75 mm	(3" x 3")	NI-T1-C	NI-T1-C1	NI-T1-C2	NI-T1-C3
100 x 50 mm	(4" x 2")	NI-T1-D	NI-T1-D1	NI-T1-D2	NI-T1-D3
100 x 75 mm	(4" x 3")	NI-T1-E	NI-T1-E1	NI-T1-E2	NI-T1-E3
100 x 100 mm	(4" x 4")	NI-T1-F	NI-T1-F1	NI-T1-F2	NI-T1-F3
150 x 50 mm	(6" x 2")	NI-T1-G	NI-T1-G1	NI-T1-G2	NI-T1-G3
150 x 75 mm	(6" x 3")	NI-T1-H	NI-T1-H1	NI-T1-H2	NI-T1-H3
150 x 100 mm	(6" x 4")	NI-T1-I	NI-T1-I1	NI-T1-I2	NI-T1-I3
150 x 150 mm	(6" x 6")	NI-T1-J	NI-T1-J1	NI-T1-J2	NI-T1-J3
200 x 100 mm	(8" x 4")	NI-T1-K	NI-T1-K1	NI-T1-K2	NI-T1-K3
300 x 100 mm	(12" x 4")	NI-T1-L	NI-T1-L1	NI-T1-L2	NI-T1-L3
450 x 100 mm	(18" x 4")	NI-T1-M	NI-T1-M1	NI-T1-M2	NI-T1-M3
600 x 100 mm	(24" x 4")	NI-T1-N	NI-T1-N1	NI-T1-N2	NI-T1-N3

INTERSECTION FOR DOUBLE COMPARTMENT

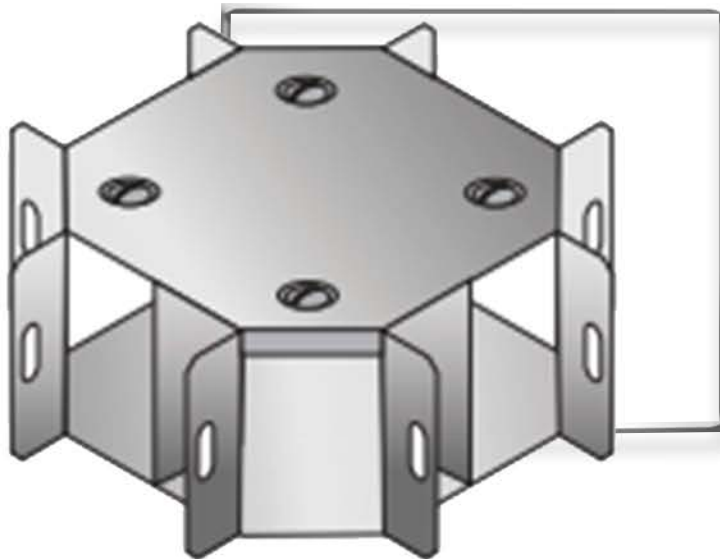

cornered / curved

Intersection For Double Compartment

Dimensions	Inch	Item Codes			
		Thickness 1 mm	Thickness 1.2 mm	Thickness 1.5 mm	Thickness 2 mm
50 x 50 mm	(2" x 2")	NI-T2-A	NI-T2-A1	NI-T2-A2	NI-T2-A3
75 x 50 mm	(3" x 2")	NI-T2-B	NI-T2-B1	NI-T2-B2	NI-T2-B3
75 x 75 mm	(3" x 3")	NI-T2-C	NI-T2-C1	NI-T2-C2	NI-T2-C3
100 x 50 mm	(4" x 2")	NI-T2-D	NI-T2-D1	NI-T2-D2	NI-T2-D3
100 x 75 mm	(4" x 3")	NI-T2-E	NI-T2-E1	NI-T2-E2	NI-T2-E3
100 x 100 mm	(4" x 4")	NI-T2-F	NI-T2-F1	NI-T2-F2	NI-T2-F3
150 x 50 mm	(6" x 2")	NI-T2-G	NI-T2-G1	NI-T2-G2	NI-T2-G3
150 x 75 mm	(6" x 3")	NI-T2-H	NI-T2-H1	NI-T2-H2	NI-T2-H3
150 x 100 mm	(6" x 4")	NI-T2-I	NI-T2-I1	NI-T2-I2	NI-T2-I3
150 x 150 mm	(6" x 6")	NI-T2-J	NI-T2-J1	NI-T2-J2	NI-T2-J3
200 x 100 mm	(8" x 4")	NI-T2-K	NI-T2-K1	NI-T2-K2	NI-T2-K3
300 x 100 mm	(12" x 4")	NI-T2-L	NI-T2-L1	NI-T2-L2	NI-T2-L3
450 x 100 mm	(18" x 4")	NI-T2-M	NI-T2-M1	NI-T2-M2	NI-T2-M3
600 x 100 mm	(24" x 4")	NI-T2-N	NI-T2-N1	NI-T2-N2	NI-T2-N3

INTERSECTION FOR TRIPLE COMPARTMENT

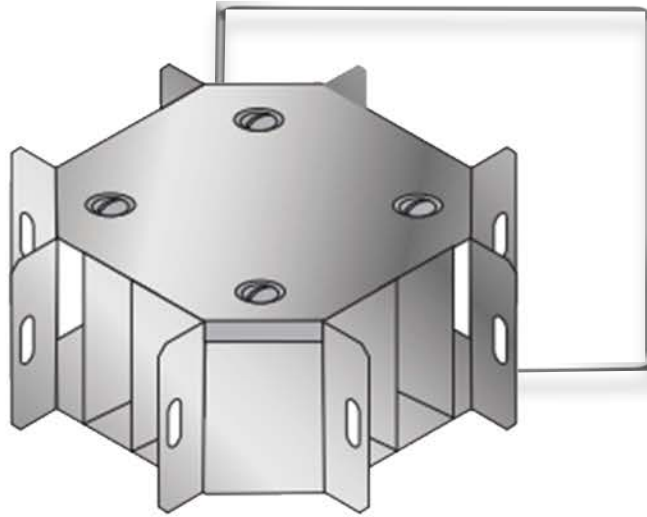

cornered / curved

Intersection For Triple Compartment

Dimensions	Inch	Item Codes			
		Thickness 1 mm	Thickness 1.2 mm	Thickness 1.5 mm	Thickness 2 mm
50 x 50 mm	(2" x 2")	NI-T3-A	NI-T3-A1	NI-T3-A2	NI-T3-A3
75 x 50 mm	(3" x 2")	NI-T3-B	NI-T3-B1	NI-T3-B2	NI-T3-B3
75 x 75 mm	(3" x 3")	NI-T3-C	NI-T3-C1	NI-T3-C2	NI-T3-C3
100 x 50 mm	(4" x 2")	NI-T3-D	NI-T3-D1	NI-T3-D2	NI-T3-D3
100 x 75 mm	(4" x 3")	NI-T3-E	NI-T3-E1	NI-T3-E2	NI-T3-E3
100 x 100 mm	(4" x 4")	NI-T3-F	NI-T3-F1	NI-T3-F2	NI-T3-F3
150 x 50 mm	(6" x 2")	NI-T3-G	NI-T3-G1	NI-T3-G2	NI-T3-G3
150 x 75 mm	(6" x 3")	NI-T3-H	NI-T3-H1	NI-T3-H2	NI-T3-H3
150 x 100 mm	(6" x 4")	NI-T3-I	NI-T3-I1	NI-T3-I2	NI-T3-I3
150 x 150 mm	(6" x 6")	NI-T3-J	NI-T3-J1	NI-T3-J2	NI-T3-J3
200 x 100 mm	(8" x 4")	NI-T3-K	NI-T3-K1	NI-T3-K2	NI-T3-K3
300 x 100 mm	(12" x 4")	NI-T3-L	NI-T3-L1	NI-T3-L2	NI-T3-L3
450 x 100 mm	(18" x 4")	NI-T3-M	NI-T3-M1	NI-T3-M2	NI-T3-M3
600 x 100 mm	(24" x 4")	NI-T3-N	NI-T3-N1	NI-T3-N2	NI-T3-N3

Type 1: inside

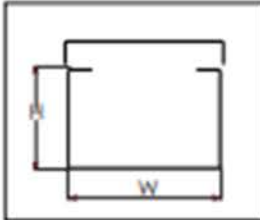

Type 2: outside

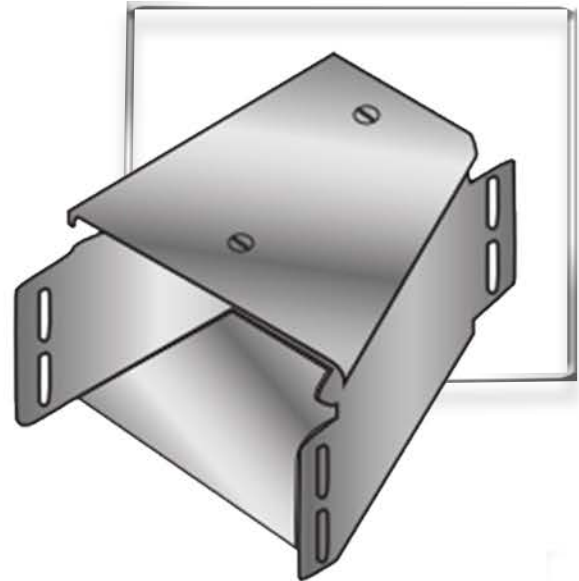
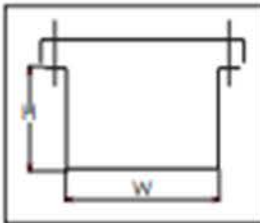

Reducer

Dimensions	Item Codes			
	Thickness 1 mm	Thickness 1.2 mm	Thickness 1.5 mm	Thickness 2 mm
75 x 75 mm - 50 x 50 mm	NR-A	NR-A1	NR-A2	NR-A3
100 x 100 mm - 100 x 50 mm	NR-B	NR-B1	NR-B2	NR-B3
100 x 100 mm - 75 x 75 mm	NR-C	NR-C1	NR-C2	NR-C3
100 x 100 mm - 50 x 50 mm	NR-D	NR-D1	NR-D2	NR-D3
150 x 150 mm - 50 x 50 mm	NR-E	NR-E1	NR-E2	NR-E3
150 x 150 mm - 75 x 75 mm	NR-F	NR-F1	NR-F2	NR-F3
150 x 150 mm - 100 x 100 mm	NR-G	NR-G1	NR-G2	NR-G3
200 x 100 mm - 100 x 100 mm	NR-H	NR-H1	NR-H2	NR-H3
200 x 100 mm - 150 x 100 mm	NR-I	NR-I1	NR-I2	NR-I3
300 x 100 mm - 100 x 100 mm	NR-J	NR-J1	NR-J2	NR-J3
300 x 100 mm - 150 x 100 mm	NR-K	NR-K1	NR-K2	NR-K3
300 x 100 mm - 100 x 100 mm	NR-L	NR-L1	NR-L2	NR-L3
450 x 100 mm - 300 x 100 mm	NR-M	NR-M1	NR-M2	NR-M3
450 x 100 mm - 200 x 100 mm	NR-N	NR-N1	NR-N2	NR-N3
450 x 100 mm - 100 x 100 mm	NR-O	NR-O1	NR-O2	NR-O3
600 x 100 mm - 450 x 100 mm	NR-P	NR-P1	NR-P2	NR-P3
600 x 100 mm - 300 x 100 mm	NR-Q	NR-Q1	NR-Q2	NR-Q3
600 x 100 mm - 200 x 100 mm	NR-R	NR-R1	NR-R2	NR-R3
600 x 100 mm - 100 x 100 mm	NR-S	NR-S1	NR-S2	NR-S3

Central Reducer Single	NCR-1
Central Reducer Double	NCR-2
Central Reducer Triple	NCR-3
Central Half Single	NCHS-1
Central Half Double	NCHD-2
Central Half Triple	NCHT-3

BELLMOUTH

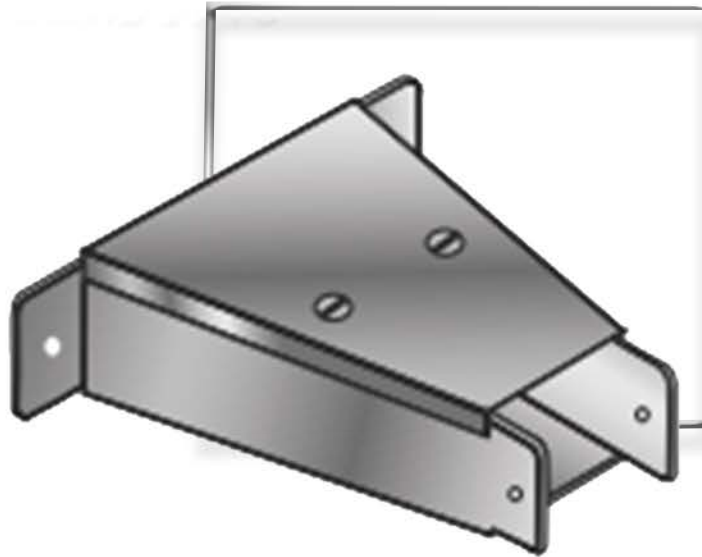

Bellmouth				
Dimensions	Item Codes			
	Thickness 1 mm	Thickness 1.2 mm	Thickness 1.5 mm	Thickness 2 mm
75 x 75 mm - 50 x 50 mm	NB-A	NB-A1	NB-A2	NB-A3
100 x 100 mm - 100 x 50 mm	NB-B	NB-B1	NB-B2	NB-B3
100 x 100 mm - 75 x 75 mm	NB-C	NB-C1	NB-C2	NB-C3
100 x 100 mm - 50 x 50 mm	NB-D	NB-D1	NB-D2	NB-D3
150 x 150 mm - 50 x 50 mm	NB-E	NB-E1	NB-E2	NB-E3
150 x 150 mm - 75 x 75 mm	NB-F	NB-F1	NB-F2	NB-F3
150 x 150 mm - 100 x 100 mm	NB-G	NB-G1	NB-G2	NB-G3
200 x 100 mm - 100 x 100 mm	NB-H	NB-H1	NB-H2	NB-H3
200 x 100 mm - 150 x 100 mm	NB-I	NB-I1	NB-I2	NB-I3
300 x 100 mm - 100 x 100 mm	NB-J	NB-J1	NB-J2	NB-J3
300 x 100 mm - 150 x 100 mm	NB-K	NB-K1	NB-K2	NB-K3
300 x 100 mm - 100 x 100 mm	NB-L	NB-L1	NB-L2	NB-L3
450 x 100 mm - 300 x 100 mm	NB-M	NB-M1	NB-M2	NB-M3
450 x 100 mm - 200 x 100 mm	NB-N	NB-N1	NB-N2	NB-N3
450 x 100 mm - 100 x 100 mm	NB-O	NB-O1	NB-O2	NB-O3
600 x 100 mm - 450 x 100 mm	NB-P	NB-P1	NB-P2	NB-P3
600 x 100 mm - 300 x 100 mm	NB-Q	NB-Q1	NB-Q2	NB-Q3
600 x 100 mm - 200 x 100 mm	NB-R	NB-R1	NB-R2	NB-R3
600 x 100 mm - 100 x 100 mm	NB-S	NB-S1	NB-S2	NB-S3

Bellmouth Single	NB-1
Bellmouth Double	NB-2
Bellmouth Triple	NB-3



شركة نبراس المعدن للصناعة
NIPRAS METAL INDUSTRY Co.



رؤية
VISION
2030
المملكة العربية السعودية
KINGDOM OF SAUDI ARABIA

CABLE TRUNK ACCESSORIES & SUPPORT SYSTEMS.



NMG NIPRAS
METAL GROUP

CRIMPING TYPE COPPER

TINNED COPPER FLEXIBLE BRAIDS

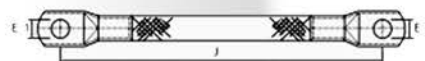
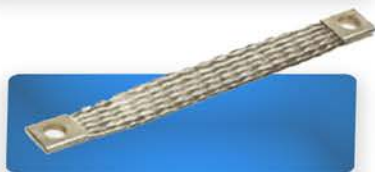
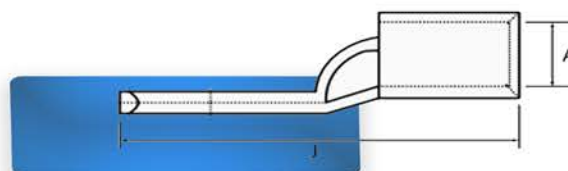
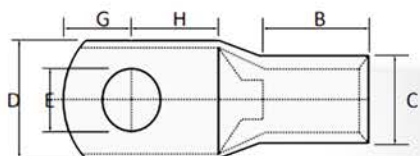
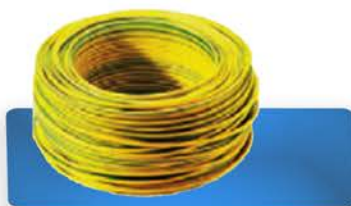

HFT- crimped with lugs

Cable mm ²	Stud Hole	Dimensions (mm)						
		A	C	D	G	H	B	J
1.5	6.5	1.8	3.7	10	4	6	6	18
2.5	6.5	2.4	4	10	5	6	8	21
	8.4	2.4	4.2	12	6	9	8	26
4	6.5	3.1	4.8	10	5	6	8	21
	8.4	3.1	5.0	12	6	9	8	26
6	6.5	3.8	5.5	10	5	6	10	24
	8.4	3.8	5.5	12	6	9	10	28
10	6.5	4.5	6.2	11	6	7	10	26
	8.4	4.5	6.2	12	6	9	10	28
16	6.5	5.4	7.1	12	7	7	12	30
	8.4	5.4	7.1	12	7	7	12	30
20	8.4	6	7.7	12	7	7	12	32
25	6.5	6.8	8.8	13	7	7	12	30
	8.4	6.8	8.8	13	7	7	12	30

Size mm ²	Dimensions (mm)			Current rating AMP
	J	E1	E2	
4	50	6	6	50
	100	6	6	
	150	6	6	
10	50	6	6	90
	100	6	6	
	150	6	6	
16	100	8.5	8.5	125
	150	8.5	8.5	
	200	8.5	8.5	125
	250	8.5	8.5	
	300	8.5	8.5	125
	100	10	10	
25	150	10	10	160
	200	10	10	
	250	10	10	160
	300	10	10	



SUPPORT SYSTEM

C - CHANNEL

N S F metal framing
C - Channel is cold formed on modern rolling machines from low carbon steel manufactured according to **BS 6946: 1988. A** continuous slot provides the ability to make attachments at any point.

LENGTHS

Standard length: 300mm with + 3.2mm length tolerance. Custom lengths are available upon request

FINISHES

Standard Finishes :
Pre-Galvanized finish (ASTM A653M coating G90 and G60). Hot Dip Galvanized after fabrication (ASTM A123 or BS EN ISO 1461:2009). **Other custom coatings are available upon request**



METAL FRAMING C - CHANNELS

Selection Chart

Part No.	Channel Dimensions		Thickness
	Height "H"	Width "W"	
C-Channel - 220/221	21.0 mm	41.0 mm	1.5 mm
C-Channel - 240/241	41.0 mm	41.0 mm	1.5 mm
C-Channel - 320/321	21.0 mm	41.0 mm	2.0 mm
C-Channel - 340/341	41.0 mm	41.0 mm	2.0 mm
C-Channel - 420/421	21.0 mm	41.0 mm	2.5 mm
C-Channel - 440/441	41.0 mm	41.0 mm	2.5 mm

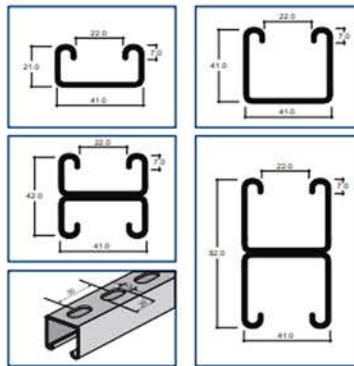

For Toothed Channel add "T" after the Part no. ex: C-CHANNEL - 220T

C - CHANNEL HOLE PATTERNS

PT Plain Type

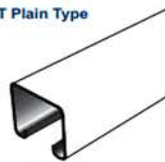

ST Slotted Type



B2B Type

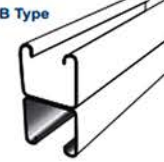

Toothed C-Channel type



PT Type Channel

Part No.	Thick. mm.	Height "H"
C-Channel - 220	1.5	21.0
C-Channel - 240	1.5	41.0
C-Channel - 320	2.0	21.0
C-Channel - 340	2.0	41.0
C-Channel - 420	2.5	21.0
C-Channel - 440	2.5	41.0

ST Type Channel

Part No.	Thick. mm.	Height "H"
C-Channel - 221	1.5	21.0
C-Channel - 241	1.5	41.0
C-Channel - 321	2.0	21.0
C-Channel - 341	2.0	41.0
C-Channel - 421	2.5	21.0
C-Channel - 441	2.5	41.0

B2B Type Channel

Part No.	Thick. mm.	Height "H"
C-Channel - 222	1.5	42.0
C-Channel - 242	1.5	82.0
C-Channel - 322	2.0	42.0
C-Channel - 342	2.0	82.0
C-Channel - 422	2.5	42.0
C-Channel - 442	2.5	82.0

For Toothed Channel add "T" after the Part no. ex: CCH-220T

CANTILEVER ARM BRACKETS - SCA

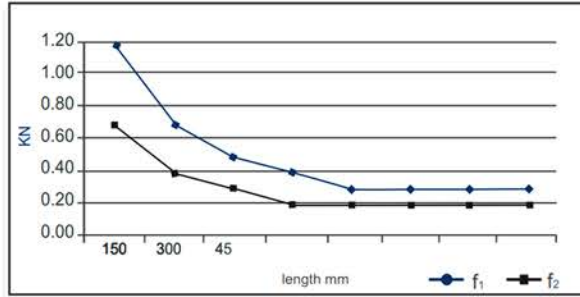
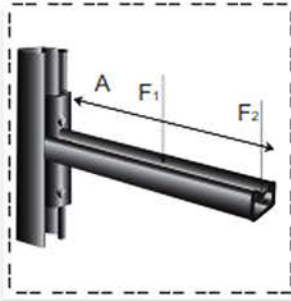

Length A (mm)	Allowable Load		
	F ₁ *	F ₂ *	F ₃ *
150	1.10	0.60	3.10
300	0.60	0.30	3.10
450	0.40	0.20	3.10
600	0.30	0.10	3.10
700	0.20	0.10	3.10
800	0.20	0.10	3.10
900	0.20	0.10	3.10
1000	0.20	0.10	3.10

BASE PLATE : height (h) x width (b) x thickness (t)
120 50 8

- In the case of concrete support, use anchor M10.
- In the case of C-Channel frame, use bolt and spring nut M8.

**** Connection force (pull out force) : 3.1 (KN).**

CCH 441 41x21x2.5

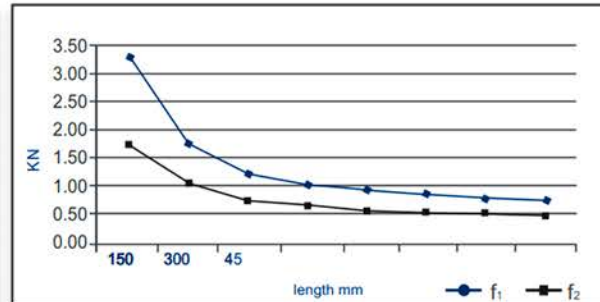
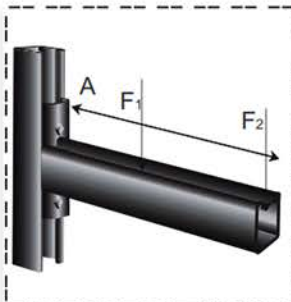

Length A (mm)	Allowable Load		
	F ₁ *	F ₂ *	F ₃ *
150	3.10	1.50	7.50
300	1.50	0.80	7.50
450	1.00	0.50	7.50
600	0.80	0.40	7.50
700	0.70	0.30	7.50
800	0.60	0.30	7.50
900	0.50	0.30	7.50
1000	0.50	0.20	7.50

BASE PLATE : height (h) x width (b) x thickness (t)
140 50 10

- In the case of concrete support, use anchor M16.
- In the case of C-Channel frame, use bolt and spring M8.

**** Connection force (pull out force) : 7.5 (KN).**

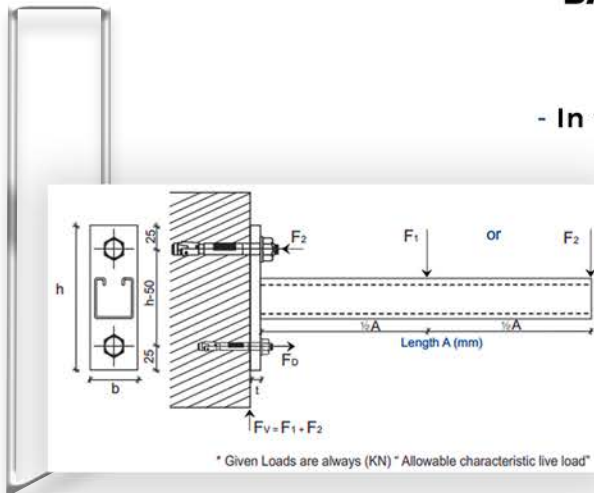

CANTILEVER ARM BRACKETS - B2B-SCA

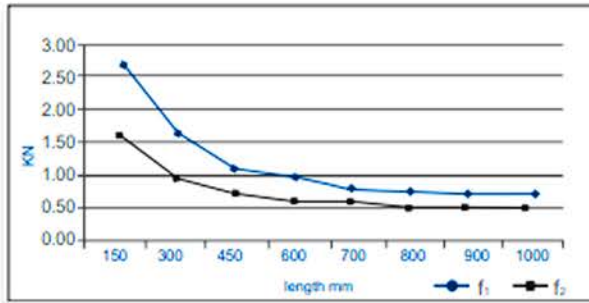
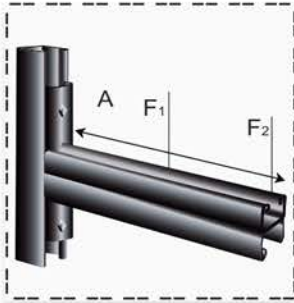

Length A (mm)	Allowable Load		
	F ₁ *	F ₂ *	F ₃ **
150	2.50	1.30	4.80
300	1.30	0.60	4.80
450	0.80	0.40	4.80
600	0.60	0.30	4.80
700	0.50	0.30	4.80
800	0.50	0.20	4.80
900	0.40	0.20	4.80
1000	0.40	0.20	4.80

BASE PLATE: height(h) x width(b) x thickness(t)

140 50 10

- In the case of concrete support, use anchor M12.
- In the case of C-Channel frame, use bolt and spring nut M8.

****Connection force (pull out force) : 4.6(KN).**

CCH 421 41x41x2.5 B2B

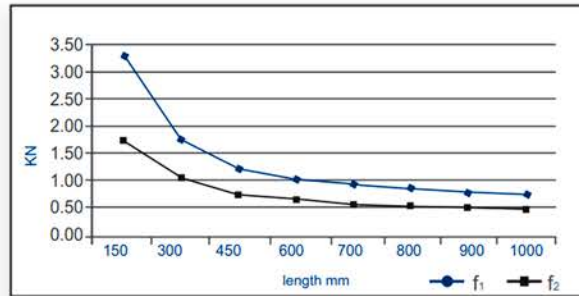
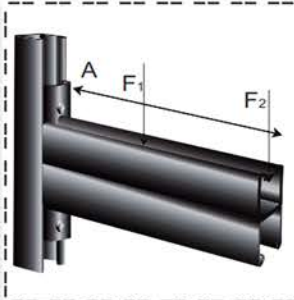

Length A (mm)	Allowable Load		
	F ₁ *	F ₂ *	F ₃ **
150	7.00	3.50	8.30
300	3.50	1.80	8.30
450	2.30	1.20	8.30
600	1.80	0.90	8.30
700	1.50	0.80	8.30
800	1.30	0.70	8.30
900	1.20	0.60	8.30
1000	1.10	0.50	8.30

BASE PLATE: height(h) x width(b) x thickness(t)

180 60 12

- In the case of concrete support, use anchor M16.
- In the case of C-Channel frame, use bolt and spring nut M10.

****Connection force (pull out force) : 8.3(KN).**

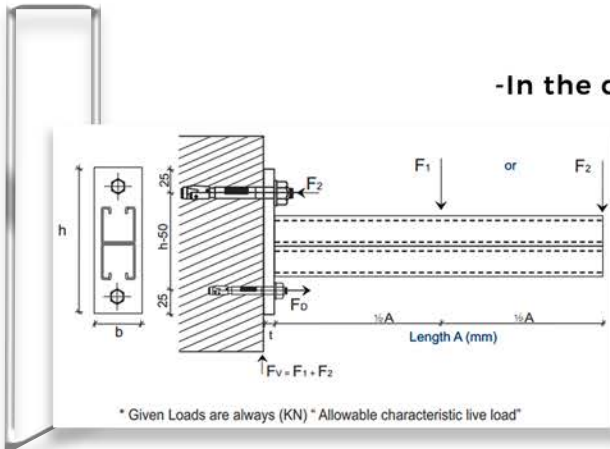

U CONNECTOR / STOP END

ASC 9020

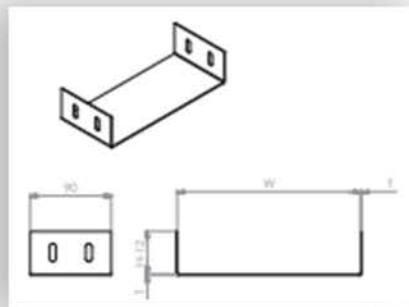

FLANGED CONNECTOR

AFC 9025

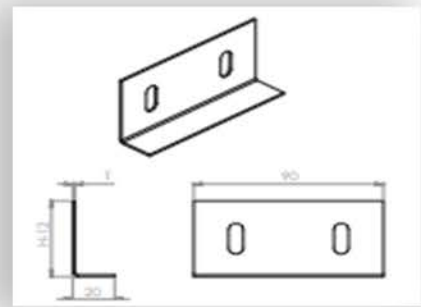

EARTH LINKS...

Features	
Lenght	55 mm
Width	10 mm
Two Slots	13 mm x 6 mm
Thickness	0.5 mm
Density	0.0024 KG
Material	Copper Coated with Electro-Nickle

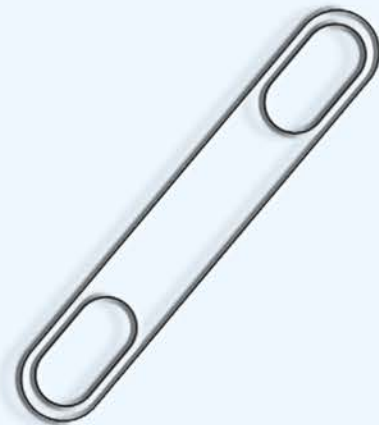

Continuity by joining two trunkings

Manufactured with improved features and equivalent to international standards **BS-763**

Application: To earth any size or any make of trunkings

SUSPENSION BRACKET

ASC 9020

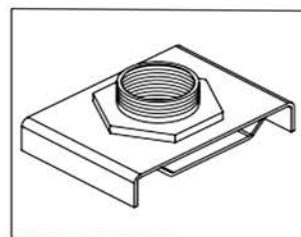

With brass & steel lock nuts

FLANGED CONNECTOR

AFC 9025

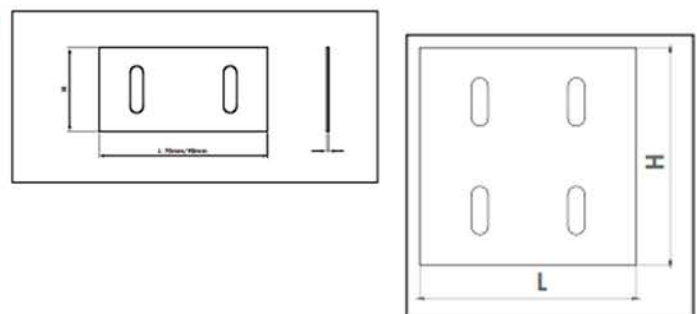



شركة نبراس المعدن للصناعة
NIPRAS METAL INDUSTRY Co.



رؤية
VISION
2030
المملكة العربية السعودية
KINGDOM OF SAUDI ARABIA

CABLE TRUNK
ORDER CODES.



NMG NIPRAS
METAL GROUP



ORDER CODES

For Cable Trunking - Length - 2440 mm / 3000 mm - Order By Code							
Item number/code	Width	Side Height	Thickness	Side / Flange type	Length	Material	Finish
NCTR-1C-A	100	50	1.0	Inside / Outside	3.00	HDG	PC
NCTR-2C-A						See Material codes table	
NCTR-3C-A							
Nipras Cable Trunk - No of Compartments							

Code Category							
Compartment	Width	Side Height	Thickness	Side / Flange type	Length	Material	Finish
	100	50	1.0	Inside / Outside	3.00	HDG	PC
Single Compartment	NCTR-1C-A		1.0	O	B	HDG	
Double Compartment	NCTR-2C-A		1.0	O	B	HDG	
Triple Compartment	NCTR-3C-A		1.0	O	B	HDG	

Example Order Code
NCTR-1C-A-1.0-O-B-HDG
NCTR-2C-A-1.0-O-B-HDG
NCTR-3C-A-1.0-O-B-HDG





RANGE OF PRODUCTS

CABLE MANAGEMENT SYSTEM

NIPRAS having a wide range of products for Cable Management system, Architectural Engineering Solutions, Building Material and more that are characterized in below categories to support the best interest for our customers.



Cable tray & Accessories



Cable ladder & Accessories

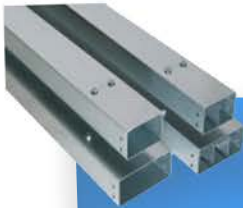

Cable trunk & Accessories

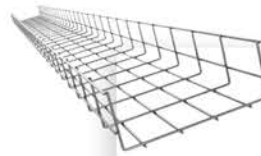

Wire basket tray & accessories



Base plate



Electrical boxes



EMT-Conduits



HFT - Crimped Terminal Lugs



Control panel boxes



C-Channel



Roof Access Hatch



Handrail



Garbage & Linen Chute



Access Raised Floor



Lockers



Ladders



Gratings (Steel / Galvanized)



Steel Bollards



Fence



Toilet Partitions



Metal Gates

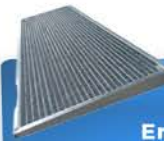

Entrance Mats



Expansion Joint System



Tile & Carpet Trim



Impact Protection

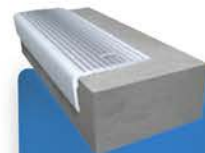

Stair Nosing

BLOCK WORK AND PLASTERING ACCESSORIES



Block Reinforcement



Steel Lintel



Adjustable head restraint

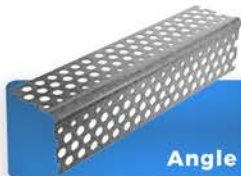

Angle Bead



Plaster Stop Bead

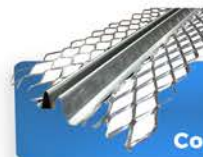

Control Joint

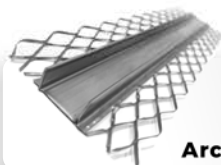

Architrave Bead



Movement Bead



Depth Gauge Bead



Corrugated Strip & Angle



Corner Mesh



Metal Sheet Lath



Strip Mesh



Coil Lath

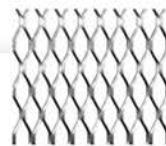

Expanded Metal Rib Lath

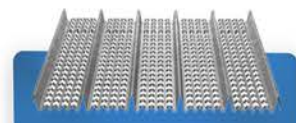

HY - Rib Lath

CONCRETE FORM WORK ACCESSORIES



Plywood



Tie Rods & Accessories



Timber



PVC Pipes

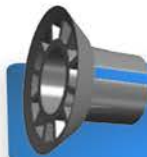

PVC Cones



PVC Chamfer



Rapid clamp



Shutter clamp



Concrete Spacer



Plastic Spacer



Steel Wire Mesh



Binding wire

WATER PROOFING & THERMAL INSULATION



Bitumen Membrane



Rock Walls



Geotextile



Extruded Polysterene

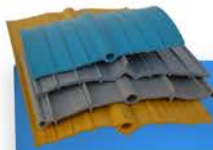

PVC Waterstop



Protection Board



Liquid Membrane

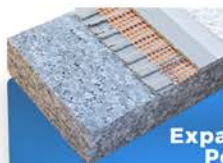

Expanded Polysterene



Foam Backing Rods



Polyethelene Sheet



Cork Sheet



Flashing Aluminium

GYPSUM PARTITIONS & SUSPENDED CEILING



Gypsum Board



Cement Board



Access Panel



Studs & Runner

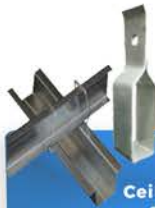

**Ceiling Furring Channel
& Channel Bracket**



**Perimeter & Dry Wall
Angle**



Furring Channel



Adjustable Rod Hanger



C- Bracket



Joint Mesh



**Wire Connecting
Clip**



Gypsum Putty



**Dry Wall & Self
Drilling Screws**

PIPE CLAMP, HANGERS & FIXING LETRING



Pipe Clamp With Rubber



Long Nut Pipe Clamp



Channel Clamp



U Clamp



Pipe Clamp (SNAP)



Beam Clamp



Conduit Clamp (Omega)



Clevis Pipe Hanger



Adjustable Band Hanger



Drop In Anchor



Anchor J Bolt



Steel U-Bolt

CLADDING ACCESSORIES



Z-Bracket With Returned Leg Horizontal Joint



Returned Leg Bracket



Up & Down Bracket



L- Bracket



Unistrut Support System & ETC



Anchor Bolt



Through Bolt



Sleeve Anchor Flange Nut



Hex Bolt With Nut Washer & Spring Nut



QUALITY POLICY

NSF is fully committed to a quality policy which ensures delivery of its products and services "defect free on time". NSF provides quality management, co-ordination, production and processing, manufacture, and installation services throughout KSA and sometimes outside KSA. Since the establishment, NSF is primarily engaged in providing Architectural Engineering solutions in the market and aims to achieve a high standard of production and trading services.



NSF POSSESS THE POLICY TO:

- ✓ Manufacture and supply products which fully confirm to the customer's requirements, relating to quality, reliability, and delivery.
- ✓ Use the company's considerable experience and knowledge in the production of standard products to assist customers in the cost-effective design and development of both existing and new products.
- ✓ Ensure that suppliers of raw materials, goods and services confirm to all requirements and are of a consistently high quality, to enable the company to achieve its commitments to all customers.
- ✓ Recognize that the responsibility for quality lies with all employees of the company and hence to stimulate and encourage interest and pride in their work.
- ✓ Hold frequent Quality Management System review meetings to enable continual review of the suitability of the Quality policy and all aspects of the Quality Management System.

These requirements of Quality Policies are compared to the requirements of ISO 9001 2015-Quality Policy. NSF strives to eliminate.





شركة نيراس المعدن للصناعة
NIPRAS METAL INDUSTRY Co.



رؤية
VISION
2030
المملكة العربية السعودية
KINGDOM OF SAUDI ARABIA

NMG NIPRAS
METAL GROUP

